

***GEAR MOTOR VC  
MANUAL***



# 小型减速电机型号定义

SMALL REDUCTION MOTOR

## 电机型号 Motor

**GH 22- 400 90 S B G1 LD**

① ② ③ ④ ⑤ ⑥ ⑦ ⑧  
图1 图2

① 结构形式	Structure form	GH卧式 GV 立式	GH Horizontal GV Vertical
② 输出轴直径	Output shaft DIA	18:Φ18mm 22: Φ22mm 28:Φ28mm X:ΦXmm	
③ 额定功率	Rated Power	100:100W 200:200W 400:400W 750:750W X:XW	
④ 减速比	Reduction Ratio	3:1:3 5:1:5 10:1:10 20:1:20 30:1:30 X:1:X	
⑤ 额定电压	Rated voltage	A : 1-Phase 单相 110V/220V C : 1-Phase 单相 220V S : 3-Phase 三相 220V/380V	
⑥ 刹车器形式	Brake unit	B : 断电刹车器 DC90V brake working when power off	
⑦ 从轴端看接线盒位置	Terminal box direction form output shaft	G1 左方向Left G2 右方向Right G3 上方向Top G4 下方向 Down	
⑧ 从轴端看出线方向	Lead wire direction form out-put shaft	T : 向上 Top D : 向下 Down F : 向前Forward B : 向后 Back L : 向左Left R : 向右 Right 图二	

图1



图2



图3

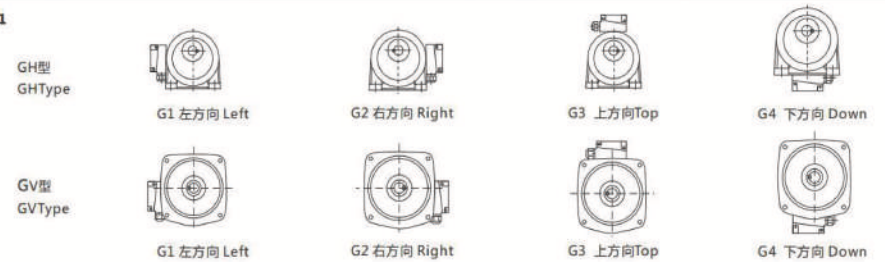

图4

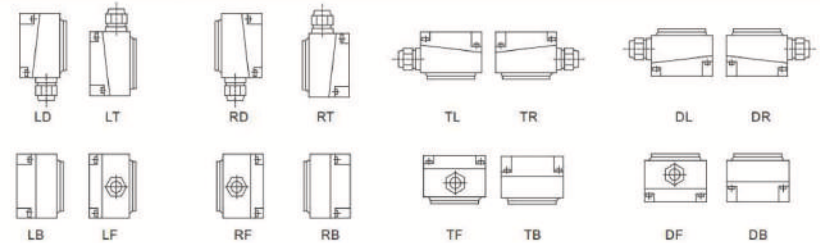

基本规范 Reduction motor specification

项目 Item	三相交流减速电机 3-Phase reduction motor	单相交流减速电机 1-Phase reduction motor
工作制式 Time duty	连续运转 Continuous running	
绝缘等级 Insulation class	B级或F级可选 Option of B class or F class	
启动方式 Starting duty	全压启动 Direct start	0.1KW/0.2KW/0.4KW 0.7KW-1.5KW
		运转电容 Running capacitor 运转/启动电容 Running & starting
适用环境 Environment	Temperature 温度 -10°C ~ +40°C	Humidity 湿度 ≤90%
减速器 Reducer	减速方式 Reduce method	齿轮减速 Gear reduce
	润滑方式 Lubricating	封闭润滑油 Lubricant
	外壳材质 Housing material	输出轴 18mm 22mm 28mm 为铝合金 32mm 40mm 50mm 为铸铁
刹车器 Brake	动作方式及使用电压 Action & Voltage 断电刹车型: DD90V Brake working when power off	

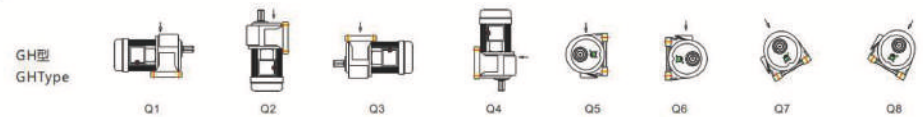
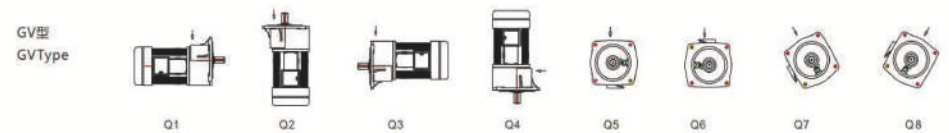
单相交流减速电机 1-Phase reduction motor 单位:A

输出功率 Output power	50Hz				60Hz			
	110V	115V	220V	230V	110V	115V	220V	230V
0.1KW	1.70	1.60	0.90	0.80	1.34	1.70	0.66	0.65
0.2KW	3.20	3.00	1.50	1.40	2.50	2.31	1.25	1.23
0.4KW	6.50	6.20	3.40	3.23	4.45	5.02	2.75	2.55
0.75KW	11.4	11.0	5.9	5.75	9.53	9.13	4.86	4.61
1.5KW	21.5	20.0	11.7	11.2	17.6	16.5	9.72	8.40

三相交流减速电机 3-Phase reduction motor 单位:A

输出功率 Output power	50Hz				60Hz			
	220V	380V	415V	440V	230V	380V	415V	440V
0.1KW	0.70	0.42	0.35	0.30	0.60	0.40	0.30	0.29
0.2KW	1.20	0.67	0.70	0.56	1.10	0.65	0.55	0.52
0.4KW	2.20	1.25	1.35	1.10	1.91	1.12	0.95	0.92
0.75KW	3.51	2.21	1.95	1.81	3.41	1.98	1.70	1.63
1.5KW	6.60	3.91	3.52	3.35	6.15	3.55	3.05	2.92
2.2KW	8.92	5.23	4.48	4.50	8.75	5.10	4.35	4.16
3KW	11.6	6.72	6.15	5.8	13.92	8.06	7.38	6.96
3.7KW	14.04	8.13	7.44	7.02	16.85	9.76	8.9	8.4
5KW	18.5	10.7	9.79	9.24	22.2	12.8	11.75	11.08
5.5KW	20.4	11.82	10.82	10.2	24.48	14.18	12.98	12.24
7.5KW	27.18	15.74	14.41	13.59	32.6	18.8	17.2	16.3

其它描述 OTHER DESCRIPTION OF REDUCTION MOTOR

最大允许轴径 Max available output shaft dim

标准输出轴径 Standard shaft dim	最大允许轴径 Max available dim
Φ18mm	Φ20mm
Φ22mm	Φ25mm
Φ28mm	Φ30mm
Φ32mm	Φ35mm
Φ40mm	Φ45mm
Φ50mm	Φ55mm
Φ60mm	Φ65mm

单相电机配套电容 Capacitor for 1-phase motor

额定功率 Rated power	运转电容 Running capacitor	启动电容 Starting capacitor
100W 1/8HP	8 μ F/450V	/
200W 1/4HP	15 μ F/450V	/
400W 1/2HP	18 μ F/450V	/
750W 1/2HP	25 μ F/450V	100 μ F/250V
1500W 2HP	35 μ F/450V	200 μ F/250V
2200W 3HP	40 μ F/450V	250 μ F/250V

选择计算示例 Calculation for selection

Example1

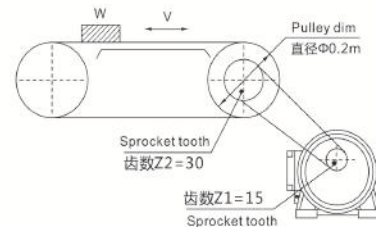

Example2

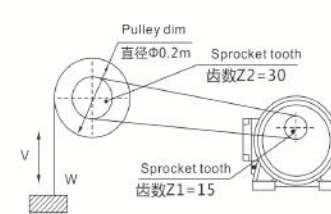

物体总重量: W=400kg	运行速度: V=80 m/min	物体与输送带摩擦系数: μ=0.15	链传动效率: η1=0.95
电机传动效率: η2=0.95	运转时间: 8 hour 小时/day 天	启动次数: 1/min	电源: 3PH 380V 50Hz

	选型计算说明 Description of calculation		Example1	Example2
	Example1	Example2		
减速比 Ratio	先确定减速电机的减速比 再求出输出轴转速 (N1); 再求出输出轴转速 (N2); 计算所需的减速比 (i) 电机转速	Calculate the reduction ratio N1 - V/(DxTT) Find the revolution of conveyer pulley first N2 - N1/(Z2/Z1) Find the output shaft revolution Calculate reduction ratio i=N2/n N: motor speed	N1=V/(DxTT)=8/(0.2x3.14)=12.7r/min N2=N1x(Z2/Z1)=12.7x(30/15)=25.4r/min i=25.4/1500≈60r/min	
扭矩 Torque	确定所需扭矩 先确定输送滚轴扭矩 (T1) 滚轮半径 R: Pulley radius	Calculate the torque by the condition of the machine used Find the torque of conveyer pulley first T1=(μxWxD/2)/η1 T1=(μ*W*R)/η1 R: Pulley radius	T1=(μxWxD/2)/η1 =(0.15x400x0.2/2)/0.95 =5.9kgf.m T2=T1x(Z1/Z2)/η2 =5.9x(15/30)/0.95 =3.10kgf.m	T1=(WxD/2)/η1 =(400x0.2/2)/0.95 =42kgf.m T2=T1x(Z1/Z2)/η2 =42x(15/30)/0.95 =22.1kgf.m
负荷条件 Load conditions	Find corrective torquer according to load condition 根据运转条件, 确定修正所需的电机扭矩 (T3) 运转系数 K: coefficient	每天使用时间 Duration of service per day	T3=T2xk =3.1x1.25 =3.875kgf.m	T3=T2xk =22.1x1.25 =27.62kgf.m
功率 Power	确定减速电机的输出功率 (P) Calculate the output power P=T3*9.8*N2/9550 (KW)		P=T3x9.8xN2/9550 =3.875x9.8x25.4/9550 0.10(KW)	P=T3x9.8xN2/9550 =27.62x9.8x25.4/9550 0.72(KW)

根据计算出的功率 (P) 和减速比 (i) 结合公司产品目录, 选择适用的减速电机型号。  
According to power (P) reduction ratio(i) and the mode-reduction ratio reference table, to select the suitable reduction motor type.

订购本公司减速电机时, 请说明以下产品信息:

减速器的基本参数 (如电机功率、减速比、输出轴直径、安装方式及产品型号等)  
关于表面喷涂, 如无指定, 本公司该系列产品的表面颜色为HL1色, 也可按用户要求  
带刹车器的减速电机总长度比不带刹车器的减速电机长度增加10mm

The customer should provide us the following information when you want to order reduction motor;  
Basic parameters of reducer (including motor power, reduction ratio, output shaft diameter, motor mode, etc.  
Painting on outside body: the color of series reduction motor is painted with H11, also we can paint according with customer's request.  
The total length of brake motors will be 10mm longer than standard motors

产品结构图 Details parts list

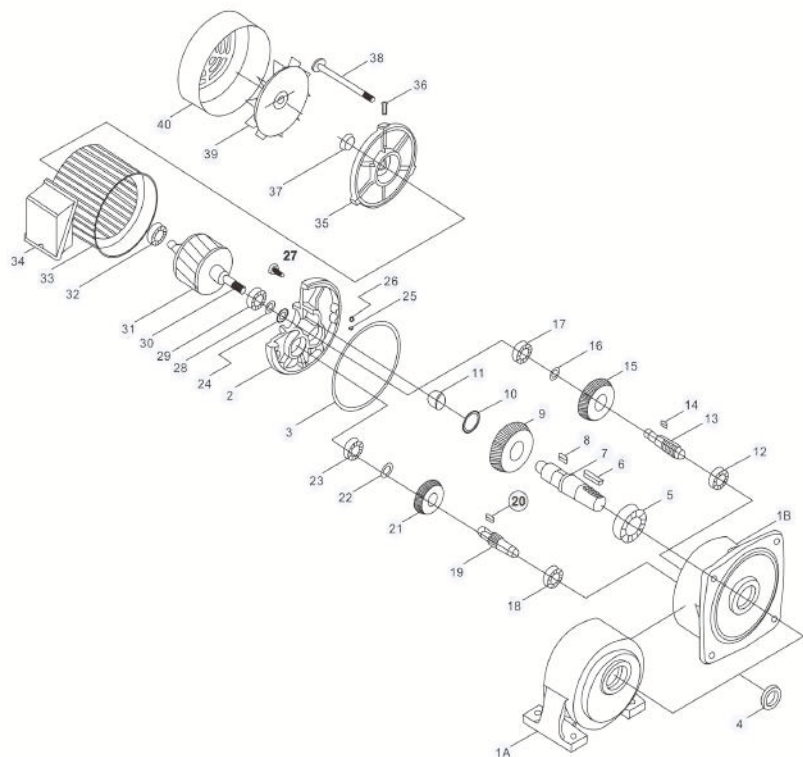

明细表 Parts List

序号 Item	名称 Name	序号 Item	名称 Name	序号 Item	名称 Name
1A	卧式 Horizontal Housing	14	三级小齿轴键 Key-3RDStage Pinion	28	玻形垫圈 Wave Spring
1B	立式 Vertical Housing	15	二级大齿轮 Gear-2ND Stage	29	电机轴承 Bearing of Shaft
2	电机前盖 Front Cover	16	C-挡圈 Snap Ring	30	电机齿轴 Motor Shaft
3	O形圈 Oil Ring	17	三级齿轴承 Bearing-3RDStage Pinion	31	转子 Rotor
4	输出轴油封 Oil Seal-Output Shaft	18	二级齿轴承 Bearing-2NDStage Pinion	32	电机轴承 Bearing of Shaft
5	输出轴承 Bearing-Output Shaft	19	二级小齿轴 Pinion-2NDStage	33	定子总成 Stator
6	输出轴键 Key-Output Shaft	20	二级小齿轴键 Key-2NDStage Pinion	34	铝接线盒 Wire Box
7	输出轴 Output Shaft	21	一级大齿轮 Gear-1ST Stage	35	电机后盖 Rear Cover
8	三级小齿轴键 Key-3RD Pinion	22	C-挡圈 Snap Ring	36	风罩螺钉 Screw-Fan Cover
9	三级大齿轮 Gear-3RD Stage	23	二级齿轴承 BEARING-2NDStage Pinion	37	后盖油封 Oil Seal-Rearcover
10	C-挡圈 Snap Ring	24	输入侧油封 Oil Seal-Motor Shaft	38	电机螺杆 Bolt
11	输出轴自润轴承 Oilless Bearing	25	定位销 Pin	39	风叶 Fan
12	二级齿轴承 Bearing-2NDStage Pinion	26	O形圈 O-Ring	40	风罩 Fan Cover
13	三级小齿轴 Pinion-3RDStage	27	由六角螺钉 Hex-Head Screw		

刹车零件分解图 Brake unit section diagram

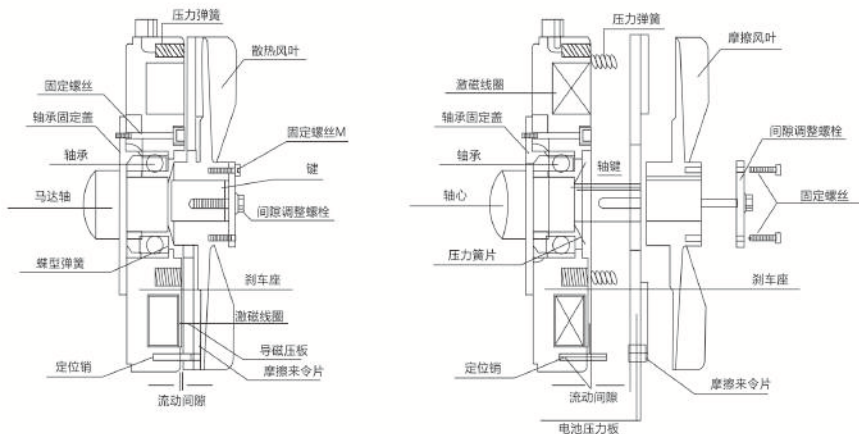

明细表 Parts List

序号 Item	名称 Name	序号 Item	名称 Name
1	压力弹簧 Pressure Spring	9	固定螺丝M Fixed Screw
2	固定螺丝 Fixed Screw	10	固键 Key
3	轴承固定盖 Fixed Bearing Cover	11	调整螺栓 Gap Adjustment Bolt
4	轴承 Bearing	12	刹车座 Brake Housing
5	马达轴 Motor Shaft	13	激磁线圈 Brake Coil
6	碟形弹簧 Disc Spring	14	导磁压板 Friction Plate
7	定位销 Fixed Pin	15	摩擦来令片 Friction Brake Disc
8	散热风叶 Fan		

接线方式 Wiring Diagram

三相 (3-phase)

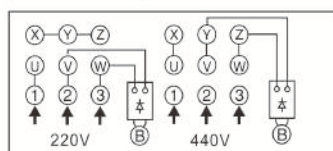
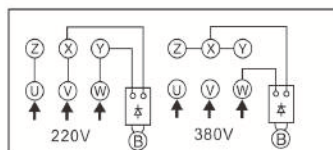
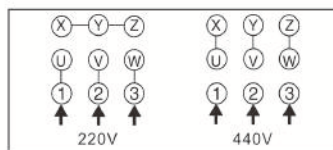
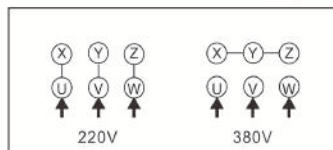

单相 (1-phase)

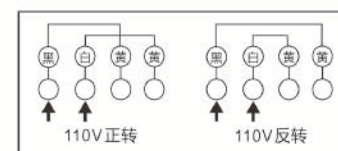
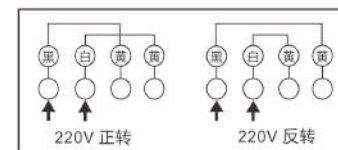
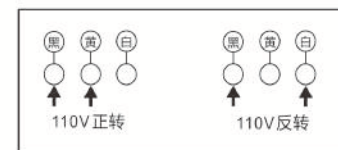
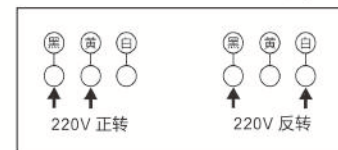

**0.1KW** 卧式/HORIZONTAL  
单相/三相/1-PHASE/3-PHASE

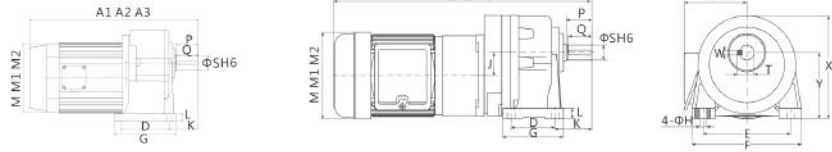

11筒电机直径是127mm，定子直径110mm

出力轴尺寸output shaft						
出力轴shaft	键槽keyway			键key		
Sh6	P	W	T	Q	SPEC	
φ18	30	5	20.2	25	5*5*25	
φ22	38	7	25	35	7*7*35	
φ28	43	7	31	40	7*7*40	
φ32	55	10	35.5	50	10*8*50	

备注：A1、M1、Z1为三相马达尺寸；  
A3为三相带刹车马达尺寸；  
A2、M2、Z2为单相马达尺寸。  
Note:A1/M1/Z1 are the sizes of three-phase motors;  
A3 is the size of three-phase motors with brakes  
A2/M2/Z2 are the sizes of single-phase motors

**0.1KW** 立式/VERTICAL  
单相/三相/1-PHASE/3-PHASE

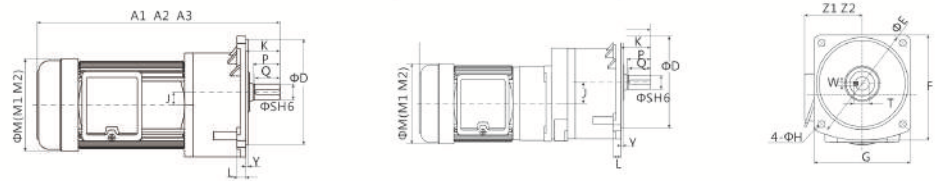

11筒电机直径是127mm，定子直径110mm

出力轴尺寸output shaft						
出力轴shaft	键槽keyway			键key		
Sh6	P	W	T	Q	SPEC	
φ18	30	5	20.2	25	5*5*25	
φ22	38	7	25	35	7*7*35	
φ28	43	7	31	40	7*7*40	

备注：A1、M1、Z1为三相马达尺寸；  
A3为三相带刹车马达尺寸；  
A2、M2、Z2为单相马达尺寸。  
Note:A1/M1/Z1 are the sizes of three-phase motors;  
A3 is the size of three-phase motors with brakes  
A2/M2/Z2 are the sizes of single-phase motors

**外形尺寸 Overall Dimensions**

功率 HP-4P	减速比 Ratio	定子直径Φ + 出轴尺寸	A1 A2 A3			D	E	F	G	H	L	J	K	罩壳直径		X	Y	Z1	Z2	重量 KG
			M1	M2																
100W 1/8HP	40K~128K	110+18	262	262	262	40	110	134.5	64	9	9.5	16	48	129	129	140.5	90	102	102	5.3
	2.5K~180K	110+22	284	284	284	65	130	162.5	90	11	15.5	18.17	60	128	128	161	98.5	102	102	6.9
	2.5K~180K	110+22(2#)	284	284	284	65	130	159	90	11	15.5	18.17	55	128	128	161	98	102	102	6.9
	2.5K~180K	110+28	309	309	309	90	140	179	122	12.5	17	36.83	64.6	128	128	187	117	102	102	13.2
	2.5K~180K	110+28(2#)	309	309	309	90	140	179	120	12.5	18.5	36.83	63.5	128	128	187	117	102	102	13.2
	250K~23000K	110+18+22	383	383	383	65	130	162.5	90	11	15.5	34.17	60	128	128	161	98.5	102	102	15
	250K~23000K	110+18+22(2#)	383	383	383	65	130	159	90	11	15.5	34.17	55	128	128	161	98	102	102	15
	250K~25000K	110+18+28	411	411	411	90	140	179	122	12.5	17	36.83	64.6	128	128	187	117	102	102	16
	250K~25000K	110+18+28(2#)	411	411	411	90	140	179	120	12.5	18.5	36.83	63.5	128	128	187	117	102	102	16
	250K~36000K	110+22+32	454	454	454	130	170	213	160	13.5	27.5	48.39	76	128	128	223	140.4	102	102	17
250K~36000K	110+22+32(2#)	454	454	454	130	170	214	160	13.5	26	48.39	70	128	128	218	141.7	102	102	17	

**外形尺寸 Overall Dimensions(短箱体 Short Case Type)**

功率 HP-4P	减速比 Ratio	定子直径Φ + 出轴尺寸	A1 A2 A3			D	E	F	G	H	L	J	K	罩壳直径		X	Y	Z1	Z2	重量 KG
			M1	M2																
100W 1/8HP	3K~30K	110+18	252	252	252	40	110	134.5	64	9	9.5	16	48	128	128	140.5	90	102	102	5.3
	250K~5400K	110+18+22	373	373	373	65	130	162.5	90	11	15.5	34.17	55	128	128	161	98.5	102	102	15
	250K~5400K	110+18+22(2#)	373	373	373	65	130	159	90	11	15.5	34.17	55	128	128	161	98	102	102	15
	250K~6000K	110+18+28	402	402	402	90	140	179	122	12.5	17	36.83	64.6	128	128	187	117	102	102	16
250K~6000K	110+18+28(2#)	401	401	401	90	140	179	120	12.5	18.5	36.83	63.5	128	128	187	117	102	102	16	

**容许转矩 ALLOWABLE TORQUE 单位：N.m**

转速 Speed RPM	转矩 Torque	减速比 Ratio																		
		3	5	7.5	10	15	20	25	30	40	50	60	85	100	108	125				
50Hz	466	280	187	140	93	70	56	47	35	28	23.3	16.5	14	13	11.2					
60Hz	560	336	224	168	112	84	67.2	56	42	33.6	28	19.8	16.8	15.6	13.4					
50Hz	2	3.4	5.1	6.8	10.3	13.6	17	20.3	27.3	34.1	41	57.9	68.2	73.5	85.3					
60Hz	1.7	2.8	4.3	5.7	8.5	11.4	14.2	17	22.7	28.4	34.1	48.2	56.8	61.2	71.3					

▲ 表列转速是基于电机异步转速 (50Hz:1400r/min、60Hz:1680r/min),额定负载时,实际转速为表列转速的80%-98%。  
缩框型为非正常设计使用,如非必要请勿选用,实际值可能与上述参数有差异,若需具体参数,敬请咨询本公司或浏览网站。  
参数可能会因技术改进而更改,恕不另行通知。未经允许,不得转载本样本的图文内容。  
1. The table speed is based on the asynchronous speed of the motor(50Hz:1400r/min、60Hz:1680r/min),the actual output speed under rated torque conditions,is about 2-20% less than synchronous speed.  
2. Light duty type is not available for standard application design,it is only suitable for special project design.As te-chnical data for these machines may be advantaged, please contact us or visit the company website.  
3. The specifications of the product may be modified for improvement without notice.Not allow for publish without formal approved.  
黄色部分不适合重载场合使用

**外形尺寸 Overall Dimensions**

功率 HP-4P	减速比 Ratio	定子直径Φ + 出轴尺寸	A1 A2 A3			D	E	F	G	H	L	J	K	罩壳直径		X	Y	Z1	Z2	重量 KG		
			M1	M2																		
100W 1/8HP	40K~128K	110+18	262	262	262	50	140	121	121	9	12	16	38	128	128			4	102	102	5.3	
	2.5K~180K	110+22	284	284	284	148	185	169	155	11	12	18.17	48	128	128			3.5	102	102	13.2	
	2.5K~180K	110+22C型法兰	284	284	284	90	139	145.5	145.5	M8			18.17	48	128	128			4.5	102	102	13.2
	2.5K~180K	110+22B型法兰	284	284	284	55	170	146.5	146.5	11	11.5	18.17	48.5	128	128			5.5	102	102	13.2	
	2.5K~180K	110+28	310	310	310	170	220	194	180	12.5	15	20.83	54	128	128			4	102	102	15	
	2.5K~180K	110+28B型法兰	310	310	310	65	200	168	168	11	13	20.83	54	128	128			5	102	102	15	
	250K~23000K	110+18+22	383	383	383	148	185	169	155	11	12	34.17	48	128	128			3.5	102	102	15	
	250K~25000K	110+18+28	411	411	411	170	220	194	180	12.5	15	36.83	54	128	128			4	102	102	16	
	250K~36000K	110+22+32	454	454	454	185	255	242	223	13.5	15	48.39	66.3	128	128			1.4	102	102	17	

**外形尺寸 Overall Dimensions(短箱体 Short Case Type)**

功率 HP-4P	减速比 Ratio	定子直径Φ + 出轴尺寸	A1 A2 A3			D	E	F	G	H	L	J	K	罩壳直径		X	Y	Z1	Z2	重量 KG	
			M1	M2																	
100W 1/8HP	3K~30K	110+18	262	252	252	50	140	121	121	9	12	16	38	128	128			4	102	102	5.3
	250K~5400K	110+18+22	373	373	388	148	185	169	155	11	12	18.17	48	128	128			3.5	102	102	13.2
	250K~6000K	110+18+28	401	401	401	170	220	194	180	12.5	15	36.83	54	128	128			4	102	102	13.2

**容许转矩 ALLOWABLE TORQUE 单位：N.m**

转速 Speed RPM	转矩 Torque	减速比 Ratio																		
		3	5	7.5	10	15	20	25	30	40	50	60	85	100	108	125				
50Hz	466	280	187	140	93	70	56	47	35	28	23.3	16.5	14	13	11.2					
60Hz	560	336	224	168	112	84	67.2	56	42	33.6	28	19.8	16.8	15.6	13.4					
50Hz	2	3.4	5.1	6.8	10.3	13.6	17	20.3	27.3	34.1	41	57.9	68.2	73.5	85.3					
60Hz	1.7	2.8	4.3	5.7	8.5	11.4	14.2	17	22.7	28.4	34.1	48.2	56.8	61.2	71.3					

▲ 表列转速是基于电机异步转速 (50Hz:1400r/min、60Hz:1680r/min),额定负载时,实际转速为表列转速的80%-98%。  
缩框型为非正常设计使用,如非必要请勿选用,实际值可能与上述参数有差异,若需具体参数,敬请咨询本公司或浏览网站。  
参数可能会因技术改进而更改,恕不另行通知。未经允许,不得转载本样本的图文内容。  
1. The table speed is based on the asynchronous speed of the motor(50Hz:1400r/min、60Hz:1680r/min),the actual output speed under rated torque conditions,is about 2-20% less than synchronous speed.  
2. Light duty type is not available for standard application design,it is only suitable for special project design.As te-chnical data for these machines may be advantaged, please contact us or visit the company website.  
3. The specifications of the product may be modified for improvement without notice.Not allow for publish without formal approved.  
黄色部分不适合重载场合使用

**0.2KW** 卧式/HORIZONTAL  
单相/三相/1-PHASE/3-PHASE

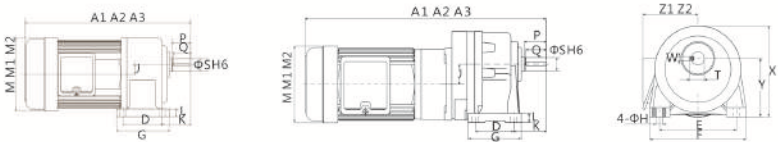

出力轴尺寸output shaft						
出力轴shaft			键槽keyway		键key	
Sh6	P	W	T	Q	SPEC	
φ18	30	5	20.2	25	5*5*25	
φ22	38	7	25	35	7*7*35	
φ28	43	7	31	40	7*7*40	
φ32	55	10	35.5	50	10*8*50	

11筒电机直径是127mm, 定子直径110mm

备注:A1、M1、Z1为三相马达尺寸;  
A3为三相带刹车马达尺寸;  
A2、M2、Z2为单相马达尺寸。  
Note:A1/M1/Z1 are the sizes of three-phase motors;  
A3 is the size of three-phase motors with brakes  
A2/M2/Z2 are the sizes of single-phase motors

外形尺寸 Overall Dimensions

功率 HP-4P	减速比 Ratio	定子直径φ +出轴尺寸	A1	A2	A3	D	E	F	G	H	L	J	K	罩壳直径		X	Y	Z1	Z2	重量 KG
														M1	M2					
200W 1/4HP	40K~128K	110+18	297	297	297	40	110	134.5	64	9	9.5	16	47.6	128	128	140.5	90	102	102	6.7
	2.5K~180K	110+22	319	319	319	65	130	162.5	90	11	15.5	18.17	60	128	128	161	98.5	102	102	8.6
	2.5K~180K	110+22(2#)	319	319	319	65	130	159	90	11	15.5	18.17	55	128	128	161	98	102	102	8.6
	2.5K~200K	110+28	346	346	346	90	140	179	122	12.5	17	20.83	64.6	128	128	187	117	102	102	11
	2.5K~200K	110+28(2#)	346	346	346	90	140	179	122	12.5	18.5	20.83	63.5	128	128	187	117	102	102	11
	250K~23000K	110+18+22	418	418	418	65	130	162.5	90	11	15.5	34.17	60	128	128	161	98.5	102	102	29.6
	250K~23000K	110+18+22(2#)	418	418	418	65	130	159	90	11	15.5	34.17	55	128	128	161	98	102	102	29.6
	250K~25000K	110+18+28	446	446	446	90	140	179	122	12.5	17	36.83	64.6	128	128	187	117	102	102	29.6
	250K~25000K	110+18+28(2#)	446	446	446	90	140	179	122	12.5	18.5	36.83	63.5	128	128	187	117	102	102	29.6
	250K~36000K	110+22+32	489	489	489	130	170	213	160	13.5	27.5	48.39	76	128	128	223	140.4	102	102	29.6
250K~36000K	110+22+32(2#)	489	489	489	130	170	214	160	13.5	26	48.39	70	128	128	218	141.7	102	102	29.6	
250K~40000K	110+28+40	555	555	555	150	210	264	190	16	26	63.03	84	128	128	264.5	162.2	132	132	29.6	
250K~38000K	110+28+50	595	595	595	170	265	335	212.5	19	30	72.53	99	129	128	326	201.7	167.5	167.5	29.6	

外形尺寸 Overall Dimensions(短箱体 Short Case Type)

功率 HP-4P	减速比 Ratio	定子直径φ +出轴尺寸	A1	A2	A3	D	E	F	G	H	L	J	K	罩壳直径		X	Y	Z1	Z2	重量 KG
														M1	M2					
200W 1/4HP	3K~30K	110+18	287	287	287	40	110	134.5	64	9	9.5	16	48	128	128	140.5	90	102	102	6.7
	250K~5400K	110+18+22	408	408	408	65	130	162.5	90	11	15.5	34.17	60	128	128	153	98.5	102	102	8.6
	250K~5400K	110+18+22(2#)	408	408	408	65	130	159	90	11	15.5	34.17	55	128	128	153	98	102	102	8.6
	250K~8000K	110+18+28	436	436	436	90	140	179	122	12.5	17	36.83	64.6	128	128	179	117	102	102	11
250K~6000K	110+18+28(2#)	436	436	436	90	140	179	122	12.5	18.5	36.83	63.5	128	128	179	117	102	102	11	

容许转矩 ALLOWABLE TORQUE 单位: N.m

减速比 Ratio	β	5	7.5	10	12.5	15	20	25	30	36	40	50	60	75	80	90	100	120	160	180	200	
																						转速 Speed RPM
50Hz	466	280	187	140	112	93	70	56	47	39	35	28	23.3	18.7	17.5	15.6	14	11.7	8.75	7.8	7	
60Hz	590	338	224	168	134	112	84	67.2	56	47	42	33.6	28	22.4	21	18.7	16.8	14	10.5	9.3	8.4	
转矩 Torque	50Hz	4.1	6.8	10.2	13.6	17.1	20.4	27.3	34.1	40.9	49.1	54.6	68.2	81.9	102	109	123	136	164	218	246	273
60Hz	3.4	5.7	8.5	11.4	14.2	17.1	22.2	28.4	34.1	40.9	45.5	56.8	68.2	85.2	91	102	114	136	182	205	227	

▲ 表列转矩是基于电机异步转速 (50Hz:1400r/min, 60Hz:1680r/min)额定负载时, 实际转速为表列转速的80%-98%。  
缩框型为非常设计使用, 如非必要请勿选用; 实际值可能与上述参数有差异, 若需具体参数, 敬请咨询本公司或浏览网站。  
参数可能会因技术改进而更改, 恕不另行通知。未经允许, 不得转载本样本的图文内容。  
1. The table speed is based on the asynchronous speed of the motor(50Hz:1400r/min, 60Hz:1680r/min), the actual output speed under rated torque conditions, is about 2~20% less than synchronous speed.  
2. Light duty type is not available for standard application design, it is only suitable for special project design. As technical data for these machines may be advantaged, please contact us or visit the company website.  
3. The specifications of the product may be modified for improvement without notice. Not allow for publish without formal approved.  
黄色部分不合适用重场合使用

**0.2KW** 立式/VERTICAL  
单相/三相/1-PHASE/3-PHASE

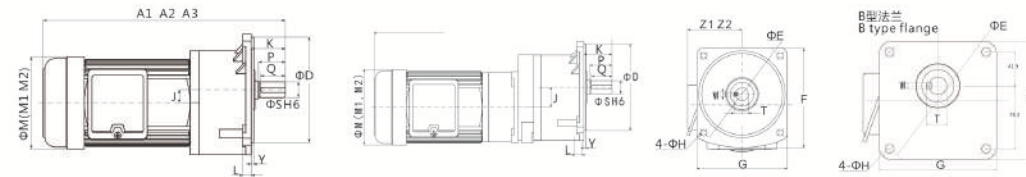

备注:A1、M1、Z1为三相马达尺寸;  
A3为三相带刹车马达尺寸;  
A2、M2、Z2为单相马达尺寸。  
Note:A1/M1/Z1 are the sizes of three-phase motors;  
A3 is the size of three-phase motors with brakes  
A2/M2/Z2 are the sizes of single-phase motors

出力轴尺寸output shaft						
出力轴shaft			键槽keyway		键key	
Sh6	P	W	T	Q	SPEC	
φ18	30	5	20.2	25	5*5*25	
φ22	38	7	25	35	7*7*35	
φ28	43	7	31	40	7*7*40	

11筒电机直径是127mm, 定子直径110mm

外形尺寸 Overall Dimensions

功率 HP-4P	减速比 Ratio	定子直径φ +出轴尺寸	A1	A2	A3	D	E	F	G	H	L	J	K	罩壳直径		X	Y	Z1	Z2	重量 KG
														M1	M2					
200W 1/4HP	40K~128K	110+18	297	297	297	50	140	121	121	9	12	16	38	128	128	4	102	102	6.9	
	2.5K~180K	110+22	319	319	319	148	185	169	155	11	12	18.17	48	128	128	3.5	102	102	8.6	
	2.5K~180K	110+22B型法兰	319	319	319	55	170	146.5	146.5	11	11.5	18.17	48.5	128	128	4.5	102	102	29.6	
	2.5K~180K	110+22C型法兰	319	319	319	90	139	145.5	145.5	M8	18.17	49	128	128	4.5	102	102	29.6		
	2.5K~200K	110+28	346	346	346	170	220	194	180	12.5	15	20.83	54	128	128	4	102	102	11	
	2.5K~200K	110+28B型法兰	346	346	346	65	200	168	168	11	13	20.83	54	128	128	5	102	102	16	
	250K~23000K	110+18+22	418	418	433	148	185	169	155	11	12	34.17	48	128	128	3.5	102	102	29.6	
	250K~25000K	110+18+22B型法兰	409	409	409	55	170	146.5	146.5	11	11.5	18.17	48.5	128	128	5.5	102	102	29.6	
	250K~25000K	110+18+22C型法兰	409	409	409	90	139	145.5	145.5	M8	18.17	49	128	128	4.5	102	102	29.6		
	250K~25000K	110+18+28	446	446	446	170	220	194	180	12.5	15	36.83	54	128	128	4	102	102	17	
250K~25000K	110+18+28B型法兰	446	446	446	65	200	168	168	11	13	20.83	54	128	128	5	102	102	17		
250K~36000K	110+22+32	489	489	489	185	255	242	223	13.5	15	48.39	66.3	128	128	1.4	111.5	111.5	29.6		
250K~40000K	110+28+40	554	554	554	230	310	300	274.5	16	21.5	63.03	76	128	128	5	138	138	29.6		
250K~38000K	110+28+50	595	595	595	280	390	361	319	19	20	72.53	85	128	128	5	159.5	159.5	29.6		

外形尺寸 Overall Dimensions(短箱体 Short Case Type)

功率 HP-4P	减速比 Ratio	定子直径φ +出轴尺寸	A1	A2	A3	D	E	F	G	H	L	J	K	罩壳直径		X	Y	Z1	Z2	重量 KG
														M1	M2					
200W 1/4HP	3K~30K	110+18	287	287	287	50	140	121	121	9	12	16	38	128	128	4	102	102	6.9	
	250K~5400K	110+18+22	408	408	423	148	185	169	155	11	12	34.17	48	128	128	3.5	102	102	29.6	
	250K~6000K	110+18+28	436	436	436	170	220	194	180	12.5	15	36.83	54	128	128	4	102	102	29.6	

容许转矩 ALLOWABLE TORQUE 单位: N.m

减速比 Ratio	β	5	7.5	10	12.5	15	20	25	30	36	40	50	60	75	80	90	100	120	160	180	200
50Hz	466	280	187	140	112	93	70	56	47	39	35	28	23.3	18.7	17.5	15.6	14	11.7	8.75	7.8	7
60Hz	590	338	224	168	134	112	84	67.2	56	47	42	33.6	28	22.4	21	18.7	16.8	14	10.5	9.3	8.4
转矩 Torque	50Hz	4.1	6.8	10.2	13.6	17.1	20.4	27.3	34.1	40.9	49.1	54.6	68.2	81.9							

**0.4/0.55KW** 卧式 / HORIZONTAL  
单相/三相/1-PHASE/3-PHASE

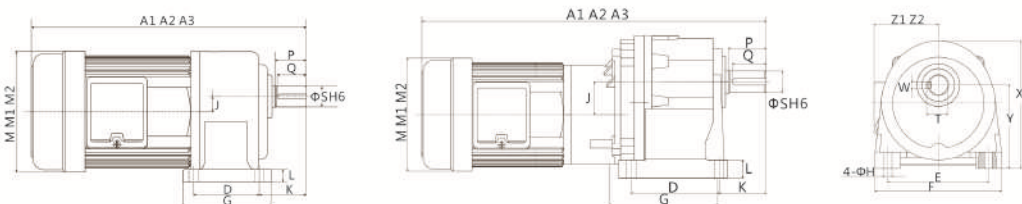

出力轴尺寸 output shaft					
出力轴 shaft	键槽 keyway		键 key		
Sh6	P	W	T	Q	SPEC
φ18	30	5	20.2	25	5*5*25
φ22	38	7	25	35	7*7*35
φ28	43	7	31	40	7*7*40
φ32	55	10	35.5	50	10*8*50

11筒电机直径是127mm, 定子直径110mm 14筒电机直径是168mm, 定子直径140mm

备注: A1、M1、Z1为三相马达尺寸;

A3为三相带刹车马达尺寸;

A2、M2、Z2为单相马达尺寸。

Note: A1/M1/Z1 are the sizes of three-phase motors;

A3 is the size of three-phase motors with brakes

A2/M2/Z2 are the sizes of single-phase motors

**0.4/0.55KW** 立式 / VERTICAL  
单相/三相/1-PHASE/3-PHASE

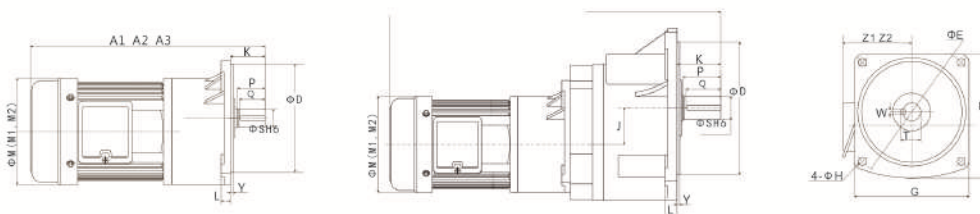

出力轴尺寸 output shaft					
出力轴 shaft	键槽 keyway		键 key		
Sh6	P	W	T	Q	SPEC
φ18	30	5	20.2	25	5*5*25
φ22	38	7	25	35	7*7*35
φ28	43	7	31	40	7*7*40
φ32	55	10	35.5	50	10*8*50

11筒电机直径是127mm, 定子直径110mm 14筒电机直径是168mm, 定子直径140mm

备注: A1、M1、Z1为三相马达尺寸;

A3为三相带刹车马达尺寸;

A2、M2、Z2为单相马达尺寸。

Note: A1/M1/Z1 are the sizes of three-phase motors;

A3 is the size of three-phase motors with brakes

A2/M2/Z2 are the sizes of single-phase motors

外形尺寸 Overall Dimensions (2#为新款减速箱)

功率 HP-4P	减速比 Ratio	定子直径φ + 出轴尺寸		A1/A2/A3	A1/A2/A3	D	E	F	G	H	L	J	K	罩壳直径		X	Y	Z1	Z2	重量 KG
		M1	M2																	
400W 1/2HP 550W 3/4HP	2.5K~200K	140+22	337	347	65	130	162.5	90	11	15.5	18.17	60	167	167	161	98.5	102	102	9/10	
	2.5K~200K	140+28	362	372	90	140	179	122	12.5	17	20.83	64.6	167	167	187	117	117	117	14	
	2.5K~200K	140+28(2#)	362	372	90	140	179	120	12.5	18.5	20.83	63.5	167	167	187	117	117	117	14	
	2.5K~200K	140+32	402	412	130	170	213	160	13.5	27.5	30.22	76	167	167	223	140.4	117	117	24	
250K~36000K	2.5K~200K	140+32(2#)	402	412	130	170	214	160	14.5	26	30.22	70	167	167	218	141.5	117	117	24	
	2.5K~200K	140+40	406	416	150	210	264	190	16	26	42.2	84	167	167	264.5	162	128	128	47	
	260K~36000K	140+22+32	505	515	130	170	213	160	13.5	27.5	48.39	76	167	167	223	140.4	117	117	26	
	260K~36000K	140+22+32(2#)	505	515	130	170	214	160	13.5	26	48.39	70	167	167	218	141.7	117	117	26	
250K~40000K	140+28+40	570	580	150	210	264	190	16	26	63.03	84	167	167	264.5	162.2	132	132	49		
	250K~38000K	140+28+50	610	620	170	265	335	212.5	19	30	72.53	99	167	167	326	201.7	167.5	167.5	49	

容许转矩 ALLOWABLE TORQUE 单位: N.m

减速比 Ratio	2.5	3	5	7	10	12.5	15	20	25	30	36	40	50	60	70	80	90	100	108	120	135	150	160	180	200	
	转速 Speed RPM	50Hz	560	466	280	200	140	112	93	70	56	47	39	35	28	23.3	20	17.5	15.6	14	13	11.7	10.4	9.3	8.75	7.8
400W扭矩 Torque	50Hz	6.72	5.60	3.36	2.40	1.68	1.34	1.12	84	67.2	56	47	42	33.6	28	24	21	18.7	16.8	15.6	14	12.4	11.2	10.5	9.3	8.4
	60Hz	6.8	5.7	3.5	2.5	1.75	1.4	1.15	90	72	59	49	43	34.5	28.8	25	22	19.8	18	16.5	14.5	12.8	11.6	10.6	9.4	8.5
550W扭矩 Torque	50Hz	9.4	7.7	4.7	3.4	2.45	1.96	1.6	126	101	84	70	63	50	42	37	33	29	26	24	21.5	19.2	17.2	15.7	14	12.6
	60Hz	9.6	8	4.9	3.5	2.55	2.0	1.65	132	106	88	73	65	51	43	38	34	30	27	25	22.5	20	18	16.2	14.4	13

▲ 表列转速是基于电机异步转速 (50Hz:1400r/min, 60Hz:1680r/min), 额定负载时, 实际转速为表列转速的80%-98%。

缩框型为非正常设计使用, 如非必要请勿选用, 实际值可能与上述参数有差异, 若需具体参数, 敬请咨询本公司或浏览网站。

参数可能会因技术改进而更改, 恕不另行通知。未经允许, 不得转载本样本的图文内容。

1. The table speed is based on the asynchronous speed of the motor(50Hz:1400r/min, 60Hz:1680r/min), the actual output speed under rated torque conditions, is about 2-20% less than synchronous speed.

2. Light duty type is not available for standard application design, it is only suitable for special project design. As technical data for these machines may be advantaged, please contact us or visit the company website.

3. The specifications of the product may be modified for improvement without notice. Not allow for publish without formal approved.

黄色部分不合适重载场合使用

外形尺寸 Overall Dimensions

功率 HP-4P	减速比 Ratio	定子直径φ + 出轴尺寸		A1/A2/A3	A1/A2/A3	D	E	F	G	H	L	J	K	罩壳直径		X	Y	Z1	Z2	重量 KG
		M1	M2																	
400W 1/2HP 550W 3/4HP	2.5K~200K	140+22	335	345	65	130	162.5	90	11	15.5	18.17	60	167	167	161	98.5	102	102	9/10	
	2.5K~200K	140+28型法兰	335	345	55	170	146.5	146.5	11	11.5	18.17	48.5	128	128		5.5	10.2	102	8.6	
	2.5K~200K	140+22型法兰	335	345	90	139	145.5	145.5	M8		18.17	49	167	167		4.5	117	117	14	
	2.5K~200K	140+28	362	372	170	220	194	180	12.5	15	20.83	54	167	167	4	117	117	14		
250K~36000K	2.5K~200K	140+28型法兰	362	372	65	200	168	168	11	13	20.83	54	128	128		5	102	102	16	
	2.5K~200K	140+32	362	372	170	220	194	180	12.5	15	20.83	54	167	167	4	117	117	14		
	250K~36000K	140+22+32	505	515	185	255	242	223	13.5	15	48.39	66.3	167	167		1.4	117	117	26	
	250K~40000K	140+28+40	570	580	230	310	300	274.5	16	21.5	63.03	76	167	167	5	138	138	49		
250K~38000K	140+28+50	610	620	280	390	361	319	19	20	72.53	85	167	167	5	159.5	159.5	49			

容许转矩 ALLOWABLE TORQUE 单位: N.m

减速比 Ratio	2.5	3	5	7	10	12.5	15	20	25	30	36	40	50	60	70	80	90	100	108	120	135	150	160	180	200	
	转速 Speed RPM	50Hz	560	466	280	200	140	112	93	70	56	47	39	35	28	23.3	20	17.5	15.6	14	13	11.7	10.4	9.3	8.75	7.8
400W扭矩 Torque	50Hz	6.72	5.60	3.36	2.40	1.68	1.34	1.12	84	67.2	56	47	42	33.6	28	24	21	18.7	16.8	15.6	14	12.4	11.2	10.5	9.3	8.4
	60Hz	6.8	5.7	3.5	2.5	1.75	1.4	1.15	90	72	59	49	43	34.5	28.8	25	22	19.8	18	16.5	14.5	12.8	11.6	10.6	9.4	8.5
550W扭矩 Torque	50Hz	9.4	7.7	4.7	3.4	2.45	1.96	1.6	126	101	84	70	63	50	42	37	33	29	26	24	21.5	19.2	17.2	15.7	14	12.6
	60Hz	9.6	8	4.9	3.5	2.55	2.0	1.65	132	106	88	73	65	51	43	38	34	30	27	25	22.5	20	18	16.2	14.4	13

▲ 表列转速是基于电机异步转速 (50Hz:1400r/min, 60Hz:1680r/min), 额定负载时, 实际转速为表列转速的80%-98%。

缩框型为非正常设计使用, 如非必要请勿选用, 实际值可能与上述参数有差异, 若需具体参数, 敬请咨询本公司或浏览网站。

参数可能会因技术改进而更改, 恕不另行通知。未经允许, 不得转载本样本的图文内容。

1. The table speed is based on the asynchronous speed of the motor(50Hz:1400r/min, 60Hz:1680r/min), the actual output speed under rated torque conditions, is about 2-20% less than synchronous speed.

2. Light duty type is not available for standard application design, it is only suitable for special project design. As technical data for these machines may be advantaged, please contact us or visit the company website.

3. The specifications of the product may be modified for improvement without notice. Not allow for publish without formal approved.

黄色部分不合适重载场合使用



**1.5/2.2KW** 卧式/HORIZONTAL  
单相/三相/1-PHASE/3-PHASE

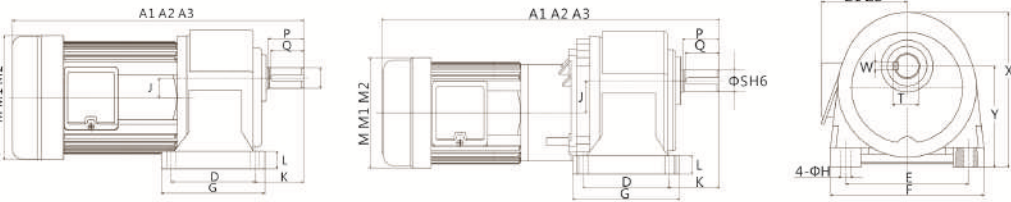

备注 A1、M1、Z1为三相马达尺寸；

A3为三相带刹车马达尺寸；

A2、M2、Z2为单相马达尺寸。

Note:A1/M1/Z1 are the sizes of three-phase motors;

A3 is the size of three-phase motors with brakes

A2/M2/Z2 are the sizes of single-phase motors

出力轴尺寸 output shaft						
出力轴 shaft		键槽 keyway			键 key	
Sh6	P	W	T	Q	SPEC	
φ28	43	7	31	40	7*7*40	
φ32	55	10	35.5	50	10*8*50	
φ40	65	10	43.5	60	10*8*60	
φ50	77	14	54	75	14*9*75	

16筒电机直径是192mm,定子直径160mm

**1.5/2.2KW** 立式/VERTICAL  
单相/三相/1-PHASE/3-PHASE

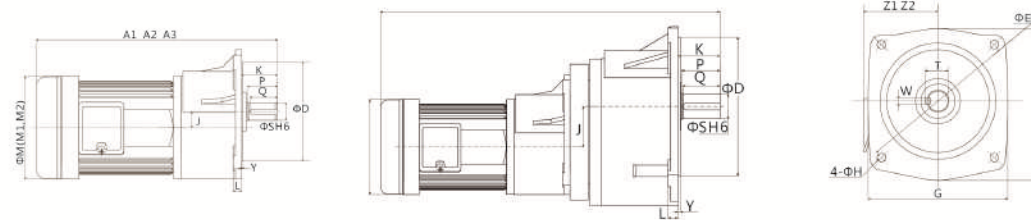

备注 A1、M1、Z1为三相马达尺寸；

A3为三相带刹车马达尺寸；

A2、M2、Z2为单相马达尺寸。

Note:A1/M1/Z1 are the sizes of three-phase motors;

A3 is the size of three-phase motors with brakes

A2/M2/Z2 are the sizes of single-phase motors

出力轴尺寸 output shaft						
出力轴 shaft		键槽 keyway			键 key	
Sh6	P	W	T	Q	SPEC	
φ28	43	7	31	40	7*7*40	
φ32	55	10	35.5	50	10*8*50	
φ40	65	10	43.5	60	10*8*60	
φ50	77	14	54	75	14*9*75	

16筒电机直径是192mm,定子直径160mm

外形尺寸 Overall Dimensions

功率 HP-4P	减速比 Ratio	定子直径Φ + 出轴尺寸	A1/A2/A3		D	E	F	G	H	L	J	K	罩壳直径		X	Y	Z1	Z2	重量 KG
			M1	M2															
1500W 2HP	3K~200K	160+28	426	456	90	140	179	122	12.5	17	20.83	64.6	193	193	192	117	128	128	15
	3K~200K	160+28(2#)	426	456	90	140	179	120	12.5	18.5	20.83	63.5	193	193	192	117	128	128	15
	3K~200K	160+32	466	496	130	170	213	160	13.5	27.5	30.22	76	193	193	223	140	128	128	34
2200W 3HP	3K~200K	160+32(2#)	466	496	130	170	214	160	14.5	26	30.22	70	193	193	218	141	128	128	34
	3K~200K	160+40	493	523	150	210	264	190	16	26	42.2	84	193	193	264.5	162	128	128	47
	3K~200K	160+40	525	555	170	265	264	190	16	26	42.2	84	193	193	264.5	162	128	128	47
2500W 3HP	250K~40000K	160+28+40	634	664	150	210	264	190	16	26	63.03	84	193	193	264.5	162	132	132	60
	250K~40000K	160+28+50	674	704	170	265	335	212.5	19	30	72.53	99	193	193	326	201	167.5	167.5	60
	250K~38000K	160+32+50	704	734	170	265	335	212.5	19	30	81.92	99	193	193	325	201	167.5	167.5	60

容许转矩 ALLOWABLE TORQUE 单位: N.m

转速 Speed RPM	减速比 Ratio	容许转矩																					
		3	4	5	6	7.5	8	10	15	20	25	30	40	50	60	75	80	100	108	125	160	180	200
1.5KW扭矩	50Hz	466	350	280	233	186	175	140	93	70	56	47	35	28	23.3	18.7	17.5	14	13	11.2	8.75	7.8	7
	60Hz	560	420	336	280	224	210	168	112	84	67.2	56	42	33.6	28	22.4	21	16.8	15.6	13.4	10.5	9.3	8.4
2.2KW扭矩	50Hz	466	350	280	233	186	175	140	93	70	56	47	35	28	23.3	18.7	17.5	14	13	11.2	8.75	7.8	7
	60Hz	560	420	336	280	224	210	168	112	84	67.2	56	42	33.6	28	22.4	21	16.8	15.6	13.4	10.5	9.3	8.4

▲ 表列转速是基于电机异步转速 (50Hz:1400r/min, 60Hz:1680r/min),额定负载时,实际转速为表列转速的80%-98%。

缩框型为非正常设计使用,如非必要请勿选用,实际值可能与上述参数有差异,若需具体参数,敬请咨询本公司或浏览网站。

参数可能会因技术改进而更改,恕不另行通知,未经允许,不得转载本样本的图文内容。

1.The table speed is based on the asynchronous speed of the motor(50Hz:1400r/min, 60Hz:1680r/min),the actual output speed under rated torque conditions, is about 2-20% less than synchronous speed

2.Light duty type is not available for standard application design,it is only suitable for special project design.As te-chnical data for these machines may be advantaged, please contact us or visit the company website.

3.The specifications of the product may be modified for improvement without notice. Not allow for publish without formal approved.

黄色部分不合适重载场合使用

外形尺寸 Overall Dimensions

功率 HP-4P	减速比 Ratio	定子直径Φ + 出轴尺寸	A1/A2/A3		D	E	F	G	H	L	J	K	罩壳直径		X	Y	Z1	Z2	重量 KG	
			M1	M2																
1500W 2HP	2.5K~200K	160+28	426	426	170	220	194	180	12.5	15	20.83	54	193	193			4	128	128	15
	2.5K~200K	160+28(2#)	426	426	65	200	168	168	11	13	20.83	54	128	128			5	102	102	16
	3K~200K	160+32	466	466	185	255	242	232	13.5	15	30.22	66.3	193	193			1.4	128	128	34
2200W 3HP	3K~200K	160+40	493	493	230	310	300	274.5	16	21.5	42.2	76	193	193			5	138	138	47
	250K~40000K	160+28+40	634	634	230	310	300	274.5	16	21.5	63.03	76	193	193			5	138	138	60
	250K~38000K	160+28+50	674	674	280	390	361	319	19	20	72.53	85	193	193			5	159.5	159.5	60
2500W 3HP	250K~38000K	160+32+50	704	704	280	390	361	319	19	20	81.92	85	193	193			5	159.5	159.5	60

容许转矩 ALLOWABLE TORQUE 单位: N.m

转速 Speed RPM	减速比 Ratio	容许转矩																					
		3	4	5	6	7.5	8	10	15	20	25	30	40	50	60	75	80	100	108	125	160	180	200
1.5KW扭矩	50Hz	466	350	280	233	186	175	140	93	70	56	47	35	28	23.3	18.7	17.5	14	13	11.2	8.75	7.8	7
	60Hz	560	420	336	280	224	210	168	112	84	67.2	56	42	33.6	28	22.4	21	16.8	15.6	13.4	10.5	9.3	8.4
2.2KW扭矩	50Hz	466	350	280	233	186	175	140	93	70	56	47	35	28	23.3	18.7	17.5	14	13	11.2	8.75	7.8	7
	60Hz	560	420	336	280	224	210	168	112	84	67.2	56	42	33.6	28	22.4	21	16.8	15.6	13.4	10.5	9.3	8.4

▲ 表列转速是基于电机异步转速 (50Hz:1400r/min, 60Hz:1680r/min),额定负载时,实际转速为表列转速的80%-98%。

缩框型为非正常设计使用,如非必要请勿选用,实际值可能与上述参数有差异,若需具体参数,敬请咨询本公司或浏览网站。

参数可能会因技术改进而更改,恕不另行通知,未经允许,不得转载本样本的图文内容。

1.The table speed is based on the asynchronous speed of the motor(50Hz:1400r/min, 60Hz:1680r/min),the actual output speed under rated torque conditions, is about 2-20% less than synchronous speed

2.Light duty type is not available for standard application design,it is only suitable for special project design.As te-chnical data for these machines may be advantaged, please contact us or visit the company website.

3.The specifications of the product may be modified for improvement without notice. Not allow for publish without formal approved.

黄色部分不合适重载场合使用

3.0/3.7/5KW

卧式/HORIZONTAL  
单相/三相/1-PHASE/3-PHASE

SMALL AC GEAR REDUCTION MOTOR  
小型交流齿轮减速电机

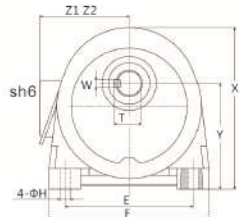
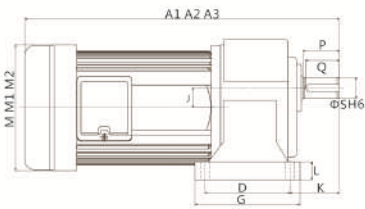

备注: A1, M1, Z1为三相马达尺寸;

A3为三相带刹车马达尺寸;

A2, M2, Z2为单相马达尺寸。

Note: A1/M1/Z1 are the sizes of three-phase motors;

A3 is the size of three-phase motors with brakes

A2/M2/Z2 are the sizes of single-phase motors

出力轴尺寸 output shaft						
出力轴 shaft	键槽 keyway				键 key	
Sh6	P	W	T	Q	SPEC	
φ32	55	10	35.5	50	10*8*50	
φ40	65	10	43.5	60	10*8*60	
φ50	77	14	54	75	14*9*75	

18脚电机直径是220mm, 定子直径180mm

3.0/3.7/5KW

立式/VERTICAL  
单相/三相/1-PHASE/3-PHASE

SMALL AC GEAR REDUCTION MOTOR  
小型交流齿轮减速电机

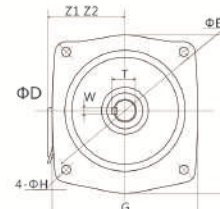
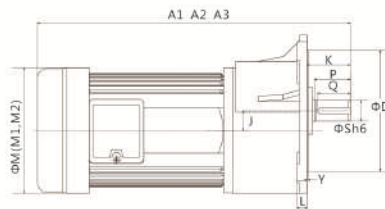

备注: A1, M1, Z1为三相马达尺寸;

A3为三相带刹车马达尺寸;

A2, M2, Z2为单相马达尺寸。

Note: A1/M1/Z1 are the sizes of three-phase motors;

A3 is the size of three-phase motors with brakes

A2/M2/Z2 are the sizes of single-phase motors

出力轴尺寸 output shaft						
出力轴 shaft	键槽 keyway				键 key	
Sh6	P	W	T	Q	SPEC	
φ32	55	10	35.5	50	10*8*50	
φ40	65	10	43.5	60	10*8*60	
φ50	77	14	54	75	14*9*75	

18脚电机直径是220mm; 定子直径180mm

外形尺寸 Overall Dimensions

功率 HP-4P	减速比 Ratio	定子直径φ + 出轴尺寸	A1	A2	A3	D	E	F	G	H	L	J	K	罩壳直径		X	Y	Z1	Z2	重量 KG
														M1	M2					
3KW 4HP	3K~200K	180+40	475	475	475	150	210	264	190	16	26	42.2	84	212	212	264.5	162.2	138	138	50
	3K~200K	180+50	518	518	518	170	265	335	212.5	19	30	81.92	99	212	212	325	201	167.5	167.5	60
	250K~4000K	180+40+50	721	721	721	170	265	335	212.5	19	30	81.92	99	212	212	325	201	167.5	167.5	60
3.7KW 5HP	3K~200K	180+40	493	493	493	150	210	264	190	16	26	42.2	84	212	212	264.5	162.2	138	138	57
	3K~200K	180+50	546	546	546	170	265	335	212.5	19	30	81.92	99	212	212	325	201	167.5	167.5	60
	250K~4000K	180+40+50	748	748	748	170	265	335	212.5	19	30	81.92	99	212	212	325	201	167.5	167.5	60
5KW 5.5HP	3K~200K	180+40	493	493	493	150	210	264	190	16	26	42.2	84	212	212	264.5	162.2	138	138	57
	3K~200K	180+50	570	570	570	170	265	335	212.5	19	30	81.92	99	212	212	325	201	167.5	167.5	60
	250K~4000K	180+40+50	777	777	777	170	265	335	212.5	19	30	81.92	99	212	212	325	201	167.5	167.5	60

容许转矩 ALLOWABLE TORQUE 单位: N.m

减速比 Ratio	3	4	5	6	8	10	15	20	25	30	40	50	60	75	80	90	100	120	140	160	180	200	
																							转速 Speed RPM
3KW转矩 Torque	61.4	81.8	102	123	164	204	307	409	512	613	818	1023	1228	1535	1637	1842	2046	2455	2865	3274	3683	4093	
3.7KW转矩 Torque	51.2	68	85	102	136	170	256	341	426	512	682	853	1023	1279	1364	1535	1705	2046	2387	2728	3069	3411	
5KW转矩 Torque	75.7	101	126	151	202	252	378	505	631	757	1009	1262	1514	1893	2019	2271	2524	3029	3533	4038	4543	5048	
5.5KW转矩 Torque	60Hz	63	84	105	126	168	210	315	420	525	630	841	1052	1262	1577	1682	1893	2103	2524	2944	3365	3785	4206
5KW转矩 Torque	50Hz	102	136	170	204	273	341	511	682	852	1023	1364	1705	2084	2558	2728	3069	3410	3873	4275	4677	5079	
5KW转矩 Torque	60Hz	85	114	142	170	227	284	426	568	710	852	1136	1421	1705	2131	2273	2558	2842	3080	3279	3547	3816	

▲ 表列转速是基于电机异步转速 (50Hz:1400r/min, 60Hz:1680r/min), 额定负载时, 实际转速为表列转速的80%-98%。

缩框型为非正常设计使用, 如非必要请勿选用, 实际值可能与上述参数有差异, 若需具体参数, 敬请咨询本公司或浏览网站。

参数可能会因技术改进而更改, 恕不另行通知, 未经允许, 不得转载本样本的图文内容。

1. The table speed is based on the asynchronous speed of the motor(50Hz:1400r/min, 60Hz:1680r/min), the actual output speed under rated torque conditions, is about 2~20% less than synchronous speed.

2. Light duty type is not available for standard application design, it is only suitable for special project design. As technical data for these machines may be advantaged, please contact us or visit the company website.

3. The specifications of the product may be modified for improvement without notice. Not allow for publish without formal approved.

黄色部分不合适重载场合使用

外形尺寸 Overall Dimensions

功率 HP-4P	减速比 Ratio	定子直径φ + 出轴尺寸	A1	A2	A3	D	E	F	G	H	L	J	K	罩壳直径		X	Y	Z1	Z2	重量 KG	
														M1	M2						
3KW 4HP	3K~200K	180+40	477	477	477	230	310	300	274.5	16	21.5	42.2	76	212	212			5	138	138	50
	3K~200K	180+50	521	521	521	280	390	361	319	19	20	72.53	85	212	212			5	159.5	159.5	60
	250K~4000K	180+40+50	728	728	728	280	390	361	319	19	20	72.53	85	212	212			5	159.5	159.5	60
3.7KW 5HP	3K~200K	180+40	496	496	496	230	310	300	274.5	16	21.5	42.2	76	212	212			5	138	138	57
	3K~200K	180+50	546	546	546	280	390	361	319	19	20	72.53	85	212	212			5	159.5	159.5	60
	250K~4000K	180+40+50	755	755	755	280	390	361	319	19	20	72.53	85	212	212			5	159.5	159.5	60
5KW 5.5HP	3K~200K	180+40	525	525	525	230	310	300	274.5	16	21.5	42.2	76	212	212			5	138	138	57
	3K~200K	180+50	568	568	568	280	390	361	319	19	20	72.53	85	212	212			5	159.5	159.5	60
	250K~4000K	180+40+50	771	771	771	280	390	361	319	19	20	72.53	85	212	212			5	159.5	159.5	60

容许转矩 ALLOWABLE TORQUE 单位: N.m

减速比 Ratio	3	4	5	6	8	10	15	20	25	30	40	50	60	75	80	90	100	120	140	160	180	200	
																							转速 Speed RPM
3KW转矩 Torque	61.4	81.8	102	123	164	204	307	409	512	613	818	1023	1228	1535	1637	1842	2046	2455	2865	3274	3683	4093	
3.7KW转矩 Torque	51.2	68	85	102	136	170	256	341	426	512	682	853	1023	1279	1364	1535	1705	2046	2387	2728	3069	3411	
5KW转矩 Torque	75.7	101	126	151	202	252	378	505	631	757	1009	1262	1514	1893	2019	2271	2524	3029	3533	4038	4543	5048	
5KW转矩 Torque	60Hz	63	84	105	126	168	210	315	420	525	630	841	1052	1262	1577	1682	1893	2103	2524	2944	3365	3785	4206
5KW转矩 Torque	50Hz	102	136	170	204	273	341	511	682	852	1023	1364	1705	2084	2558	2728	3069	3410	3873	4275	4677	5079	
5KW转矩 Torque	60Hz	85	114	142	170	227	284	426	568	710	852	1136	1421	1705	2131	2273	2558	2842	3080	3279	3547	3816	

▲ 表列转速是基于电机异步转速 (50Hz:1400r/min, 60Hz:1680r/min), 额定负载时, 实际转速为表列转速的80%-98%。

缩框型为非正常设计使用, 如非必要请勿选用, 实际值可能与上述参数有差异, 若需具体参数, 敬请咨询本公司或浏览网站。

参数可能会因技术改进而更改, 恕不另行通知, 未经允许, 不得转载本样本的图文内容。

1. The table speed is based on the asynchronous speed of the motor(50Hz:1400r/min, 60Hz:1680r/min), the actual output speed under rated torque conditions, is about 2~20% less than synchronous speed.

2. Light duty type is not available for standard application design, it is only suitable for special project design. As technical data for these machines may be advantaged, please contact us or visit the company website.

3. The specifications of the product may be modified for improvement without notice. Not allow for publish without formal approved.

黄色部分不合适重载场合使用

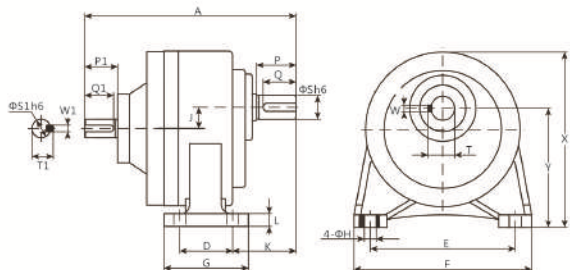

外形尺寸 Overall Dimensions 卧式 HORIZONTAL

功率/马力 WHP	减速比 Gear ratio	A	D	E	F	G	H	L	J	K	M	X	Y	出力轴 Output shaft					入力轴 Input					重量 KG
														P	Q	S	T	W	P	Q	S	T	W	
100W 1/8HP	3-50	168	40	110	135	65	9	16	16	48	72.5	132	88.5	30	25	18	20	5	25	22	14	16	5	3
	60-200	200	65	130	160	90	11	18.2	18.2	56	79.3	152	97.5	40	35	22	25	7	25	22	14	16	5	4
200W 1/4HP	3-10	168	40	110	135	65	9	16	16	48	72.5	132	88.5	30	25	18	20	5	25	22	14	16	5	3
	15-90	200	65	130	160	90	11	18.2	18.2	56	79.3	152	97.5	40	35	22	25	7	25	22	14	16	5	5
	11-200	258	90	140	180	120	11	20.8	20.8	66	85.2	180	116	45	40	28	31	7	25	22	14	16	5	7
400W 1/2HP	3-10	207	65	130	160	90	11	18.2	18.2	56	79.3	152	97.5	40	35	22	25	7	30	27	14	16	5	6
	15-90	263	90	140	178	120	11	20.8	20.8	66	95.2	180	116	45	40	28	31	7	30	27	14	16	5	7
	100-200	300	130	170	215	160	13	30.2	30.2	76	108.3	210	138.5	55	50	32	35.5	10	30	27	14	16	5	19
750W 1HP	3-25	269	90	140	178	120	11	20.8	20.8	66	95.2	180	116	45	40	28	31	7	40	35	19	21.5	6	7
	30-120	310	130	170	215	160	13	30.2	30.2	76	108.3	210	138.5	55	50	32	35.5	10	40	35	19	21.5	6	21
1500W 2HP	125-200	336	150	210	268	185	15	42.2	42.2	85	117.8	248	160	65	60	40	43.5	10	40	35	19	21.5	6	35
	3-25	320	130	170	215	160	13	30.2	30.2	76	108.3	210	138.5	55	50	32	35.5	10	50	40	24	27.5	8	21
2200W3HP	30-120	350	160	210	268	185	15	42.2	42.2	85	117.8	248	160	65	60	40	43.5	10	50	40	24	27.5	8	35
	4-60	360	150	210	268	185	15	42.2	42.2	85	117.8	248	160	65	60	40	43.5	10	50	40	24	27.5	8	35

高速比实际减速比 Actual ratio

功率 Power	减速比 Gear Ratio	250	300	350	400	450	500	600	700	800	900	1000	1100	1200	1300	1400	1500	1600	1650	1700	1800
		0.1KW	258.02	306.03	354.98	389.75	468.00	528.35	600.78	700.07	825.28	922.95	1008.09	1097.35	1224.82	1329.80	1374.44	1517.32	1582.76		
0.2KW	267.07	304.74	367.70	377.61	435.77	496.40	566.42	704.66	805.32	894.80	1036.04	1118.51	1172.26	1291.19	1393.98	1540.55	1613.99			1685.55	1838.52
0.4KW	250.05	282.89	357.57	401.21	468.71	510.97	605.37	701.91	810.36	893.94	1014.40	1102.53	1214.91	1298.22		1484.89	1574.88			1728.08	1821.00
0.75KW	244.62	299.84	359.81	381.87	458.24	518.42	602.14	703.57	814.66	921.64	985.00	1114.35	1199.37			1492.43	1612.36				1832.99

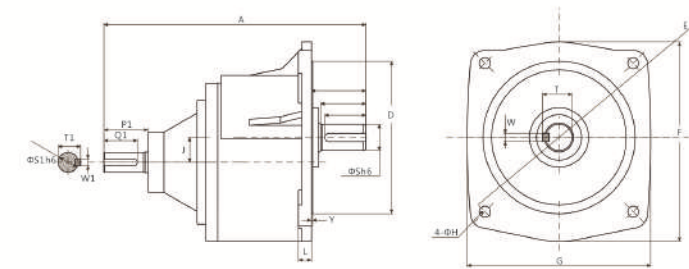

外形尺寸 Overall Dimensions 立式 VERTICAL

功率/马力 WHP	减速比 Gear ratio	A	D	E	F	G	H	L	J	K	M	X	Y	出力轴 Output shaft					入力轴 Input					重量 KG
														P	Q	S	T	W	P	Q	S	T	W	
100W 1/8HP	3-50	168	50	140	120	120	9	10	16	39			5	30	25	18	20	5	25	22	14	16	5	3
	60-200	200	148	185	156	156	11	18.2	12	47			3.5	40	35	22	25	7	25	22	14	16	5	4
200W 1/4HP	3-10	168	50	140	120	120	9	16	10	39			5	30	25	18	20	5	25	22	14	16	5	3
	15-90	200	148	185	156	156	11	18.2	12	47			3.5	40	35	22	25	7	25	22	14	16	5	5
	11-200	258	170	220	180	180	11	20.8	13	54			4	45	40	28	31	7	25	22	14	16	5	7
400W 1/2HP	3-10	207	148	185	156	156	11	18.2	12	47			3.5	40	35	22	25	7	30	27	14	16	5	6
	15-90	263	170	220	180	180	11	20.8	13	54			4	45	40	28	31	7	30	27	14	16	5	7
	100-200	300	185	255	225	225	13	30.2	15	68			4	55	50	32	35.5	10	30	27	14	16	5	19
750W 1HP	3-25	268	170	220	180	180	11	20.8	13	54			4	45	40	28	31	7	40	35	19	21.5	6	7
	30-120	310	185	255	225	225	13	30.2	15	68			4	55	50	32	35.5	10	40	35	19	21.5	6	21
1500W 2HP	125-200	336	230	310	270	270	15	42.2	20	80			5	65	60	40	43.5	10	40	35	19	21.5	6	35
	3-25	320	185	255	220	225	13	30.2	15	68			4	55	50	32	35.5	10	50	40	24	27.5	8	21
	30-120	350	230	310	270	270	15	42.2	20	80			5	65	60	40	43.5	10	50	40	24	27.5	8	35
2200W3HP	4-60	360	230	295	270	270	15	42.2	20	80			5	65	60	40	43.5	10	60	40	24	31	8	35

高速比实际减速比 Actual ratio

功率 Power	减速比 Gear Ratio	250	300	350	400	450	500	600	700	800	900	1000	1100	1200	1300	1400	1500	1600	1650	1700	1800
		0.1KW	258.02	306.03	354.98	389.75	468.00	528.35	600.78	700.07	825.28	922.95	1008.09	1097.35	1224.82	1329.80	1374.44	1517.32	1582.76		
0.2KW	267.07	304.74	367.70	377.61	435.77	496.40	566.42	704.66	805.32	894.80	1036.04	1118.51	1172.26	1291.19	1393.98	1540.55	1613.99			1685.55	1838.52
0.4KW	250.05	282.89	357.57	401.21	468.71	510.97	605.37	701.91	810.36	893.94	1014.40	1102.53	1214.91	1298.22		1484.89	1574.88			1728.08	1821.00
0.75KW	244.62	299.84	359.81	381.87	458.24	518.42	602.14	703.57	814.66	921.64	985.00	1114.35	1199.37			1492.43	1612.36				1832.99

0.4KW

卧式 / HORIZONTAL  
单相/三相/1-PHASE/3-PHASE

SMALL AC GEAR REDUCTION MOTOR  
小型交流齿轮减速电机

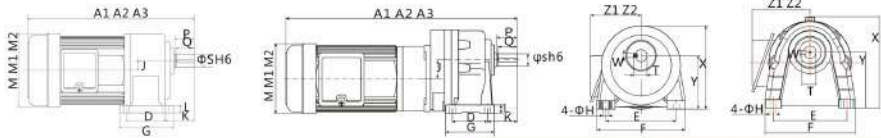

出力轴尺寸 output shaft					
出力轴 shaft	键槽 keyway			键 key	
Sh6	P	W	T	Q	SPEC
φ18	30	5	20.2	25	5*5*25
φ22	38	7	25	35	7*7*35
φ28	43	7	31	40	7*7*40
φ32	55	10	35.5	50	10*8*50
φ40	65	10	43.5	60	10*8*60
φ50	77	14	54	75	14*9*75

11号电机直径是127mm, 定子直径110mm 14号电机直径是168mm, 定子直径140mm

备注: A1, M1, Z1为三相马达尺寸;  
A3为三相带刹车马达尺寸;  
A2, M2, Z2为单相马达尺寸。  
Note: A1/M1/Z1 are the sizes of three-phase motors;  
A3 is the size of three-phase motors with brakes;  
A2/M2/Z2 are the sizes of single-phase motors

外形尺寸 Overall Dimensions (2#箱体为新款)

功率 HP-4P	减速比 Ratio	定子直径Φ + 出轴尺寸	A1	A2	A3	D	E	F	G	H	L	J	K	罩壳直径		X	Y	Z1	Z2	重量 KG
														M1	M2					
400W 1/2HP	40K~128K	110+18	316	316	316	40	110	134.5	64	9	9.5	16	48	128	128	140.5	90	102	102	6.7
	2.5K~180K	110+22	338	338	338	65	130	162.5	90	11	15.5	18.17	60	128	128	161	98.5	102	102	8.6
	2.5K~180K	110+22(2#)	338	338	338	65	130	159	90	11	15.5	18.17	55	128	128	161	98	102	102	8.6
	2.5K~200K	110+28	366	366	366	90	140	179	122	12.5	17	20.83	64.6	128	128	187	117	102	102	11
	2.5K~200K	110+28(2#)	366	366	366	90	140	179	120	12.5	18.5	20.83	63.5	128	128	187	117	102	102	11
	250K~23000K	110+18+22	437	437	437	65	130	162.5	90	11	15.5	34.17	60	128	128	161	98.5	102	102	8.6
	250K~23000K	110+18+22(2#)	437	437	437	65	130	159	90	11	15.5	34.17	55	128	128	161	98	102	102	8.6
	250K~25000K	110+18+28	465	465	465	90	140	179	122	12.5	17	36.83	64.6	128	128	187	117	102	102	8.6
	250K~25000K	110+18+28(2#)	465	465	465	90	140	179	120	12.5	18.5	36.83	63.5	128	128	187	117	102	102	8.6
	250K~36000K	110+22+32	508	508	508	130	170	213	160	13.5	27.5	48.39	76	128	128	223	140.4	106.5	106.5	8.6
400W 1/2HP	250K~36000K	110+22+32(2#)	508	511	511	130	170	214	160	13.5	26	48.39	70	128	128	218	141.7	107	107	8.6
	250K~40000K	110+28+40	574	574	574	150	210	264	190	16	26	63.03	84	128	128	264.5	162.2	132	132	8.6
	250K~38000K	110+28+50	614	614	614	170	265	335	212.5	19	30	72.53	99	128	128	326	201.7	167.5	167.5	8.6

外形尺寸 Overall Dimensions (短箱体)

功率 HP-4P	减速比 Ratio	定子直径Φ + 出轴尺寸	A1	A2	A3	D	E	F	G	H	L	J	K	罩壳直径		X	Y	Z1	Z2	重量 KG
														M1	M2					
400W 1/2HP	3K~30K	110+18	306	306	306	40	110	134.5	64	9	9.5	16	48	128	128	140.5	90	102	102	6.7
	250K~5400K	110+18+22	427	427	427	65	130	162.5	90	11	15.5	34.17	60	128	128	161	98.5	102	102	8.6
	250K~5400K	110+18+22(2#)	427	427	427	65	130	159	90	11	15.5	34.17	55	128	128	161	98	102	102	8.6
	250K~6000K	110+18+28	455	455	455	90	140	179	122	12.5	17	36.83	64.6	128	128	187	117	102	102	8.6
400W 1/2HP	250K~6000K	110+18+28(2#)	455	455	455	90	140	179	120	12.5	18.5	36.83	63.5	128	128	187	117	102	102	8.6

容许转矩 ALLOWABLE TORQUE 单位: N.m

减速比 Ratio	3	5	7.5	10	12.5	15	20	25	30	36	40	50	60	75	80	90	100	120	160	180	200	
转速 Speed RPM	50Hz	466	280	187	140	112	93	70	56	47	39	35	28	23.3	18.7	17.5	15.6	14	11.7	8.75	7.8	7
转矩 Torque	50Hz	560	336	224	168	134	112	84	67.2	56	47	42	33.6	28	22.4	21	18.7	16.8	14	10.5	9.3	8.4
	60Hz	8.2	13.6	20.5	27.3	34.1	40.9	54.5	68.2	81.9	98.2	109	136	164	205	218	246	273	327	436	491	546
	60Hz	6.8	11.4	17	22.7	28.4	34.1	45.5	56.8	68.2	81.9	91	114	136	171	182	205	227	273	364	409	455

▲ 表列转速是基于电机异步转速 (50Hz:1400r/min, 60Hz:1680r/min), 额定负载时, 实际转速为表列转速的80%-98%。  
 箱体型为非常设计使用, 如非必要请勿选用, 实际值可能与上述参数有差异, 若需具体参数, 敬请咨询本公司或浏览网站。  
 参数可能会因技术改进而更改, 恕不另行通知。未经允许, 不得转载本样本的图文内容。  
 1. The table speed is based on the asynchronous speed of the motor(50Hz:1400r/min, 60Hz:1680r/min), the actual output speed under rated torque conditions, is about 2-20% less than synchronous speed.  
 2. Light duty type is not available for standard application design, it is only suitable for special project design. As technical data for these machines may be advantaged, please contact us or visit the company website.  
 3. The specifications of the product may be modified for improvement without notice. Not allow for publish without formal approved.  
 棕色部分不合适重载场合使用

0.4KW

立式 / VERTICAL  
单相/三相/1-PHASE/3-PHASE

SMALL AC GEAR REDUCTION MOTOR  
小型交流齿轮减速电机

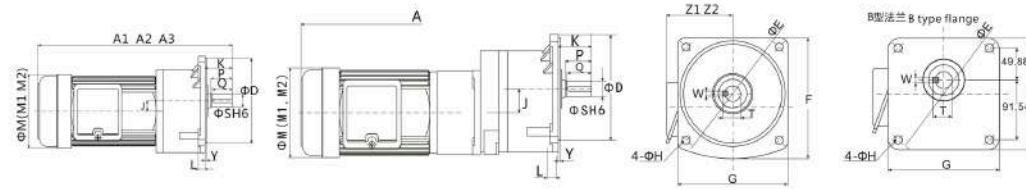

备注: A1, M1, Z1为三相马达尺寸;  
A3为三相带刹车马达尺寸;  
A2, M2, Z2为单相马达尺寸。  
Note: A1/M1/Z1 are the sizes of three-phase motors;  
A3 is the size of three-phase motors with brakes;  
A2/M2/Z2 are the sizes of single-phase motors

出力轴尺寸 output shaft					
出力轴 shaft	键槽 keyway			键 key	
Sh6	P	W	T	Q	SPEC
φ18	30	5	20.2	25	5*5*25
φ22	38	7	25	35	7*7*35
φ28	43	7	31	40	7*7*40
φ32	55	10	35.5	50	10*8*50

11号电机直径是127mm, 定子直径110mm 14号电机直径是168mm, 定子直径140mm

外形尺寸 Overall Dimensions

功率 HP-4P	减速比 Ratio	定子直径Φ + 出轴尺寸	A1	A2	A3	D	E	F	G	H	L	J	K	罩壳直径		X	Y	Z1	Z2	重量 KG	
														M1	M2						
400W 1/2HP	40K~128K	110+18	316	316	316	50	140	121	121	9	12	16	38	128	128			4	102	102	6.7
	2.5K~180K	110+22	338	338	338	148	185	169	155	11	12	18.17	48	128	128			3.5	102	102	8.6
	2.5K~180K	110+22(2#)	338	338	338	55	170	146.5	146.5	11	11.5	18.17	48.5	128	128			5.5	102	102	8.6
	2.5K~180K	110+22C型法兰	338	338	338	90	139	145.5	145.5	M8		18.17	49	128	128			4.5	102	102	8.6
	2.5K~200K	110+28	365	365	365	170	220	194	180	12.5	15	20.83	54	128	128			4	102	102	11
	2.5K~200K	110+28(2#)	365	365	365	65	200	168	168	11	13	20.83	54	128	128			5	102	102	11
	250K~23000K	110+18+22	437	437	437	148	185	169	155	11	12	34.17	48	128	128			3.5	102	102	12
	250K~23000K	110+18+22(2#)	437	437	437	55	170	146.5	146.5	11	11.5	18.17	48.5	128	128			5.5	102	102	8.6
	250K~23000K	110+18+22C型法兰	428	428	428	90	139	145.5	145.5	M8		18.17	49	128	128			4.5	102	102	8.6
	250K~25000K	110+18+28	456	456	456	170	220	194	180	12.5	15	36.83	54	128	128			4	102	102	13
400W 1/2HP	250K~25000K	110+18+28(2#)	456	456	456	65	200	168	168	11	13	20.83	54	128	128			5	102	102	16
	250K~36000K	110+22+32	508	508	508	185	255	242	223	13.5	15	48.39	66.3	128	128			1.4	111.5	111.5	15
	250K~40000K	110+28+40	574	574	574	230	310	300	274.5	16	21.5	63.03	76	128	128			5	138	138	16
	250K~38000K	110+28+50	614	614	614	280	390	361	319	19	20	72.53	85	128	128			5	159.5	159.5	17

外形尺寸 Overall Dimensions (短箱体)

功率 HP-4P	减速比 Ratio	定子直径Φ + 出轴尺寸	A1	A2	A3	D	E	F	G	H	L	J	K	罩壳直径		X	Y	Z1	Z2	重量 KG	
														M1	M2						
400W 1/2HP	3K~30K	110+18	306	306	306	50	140	128	121	9	12	16	38	128	128			4	102	102	6.7
	250K~5400K	110+18+22	427	427	427	148	185	169	155	11	12	34.17	48	128	128			3.5	102	102	8.6
400W 1/2HP	250K~6000K	110+18+28	455	455	455	170	220	194	180	12.5	15	36.83	54	128	128			4	102	102	8.6

容许转矩 ALLOWABLE TORQUE 单位: N.m

减速比 Ratio	3	5	7.5	10	12.5	15	20	25	30	36	40	50	60	75	80	90	100	120	160	180	200	
转速 Speed RPM	50Hz	466	280	187	140	112	93	70	56	47	39	35	28	23.3	18.7	17.5	15.6	14	11.7	8.75	7.8	7
转矩 Torque																						

5/5.5/7.5KW

卧式 / HORIZONTAL  
单相/三相/1-PHASE/3-PHASE

SMALL AC GEAR REDUCTION MOTOR  
小型交流齿轮减速电机

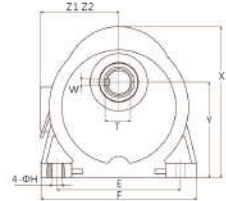
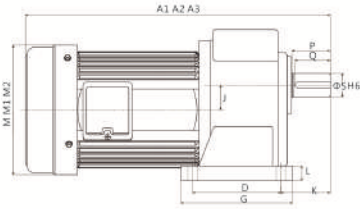

备注: A1、M1、Z1为三相马达尺寸;

A3为三相带刹车马达尺寸;

A2、M2、Z2为单相马达尺寸。

Note: A1/M1/Z1 are the sizes of three-phase motors;

A3 is the size of three-phase motors with brakes

A2/M2/Z2 are the sizes of single-phase motors

出力轴尺寸 output shaft					
出力轴 shaft	键槽 keyway			键 key	
Sh6	P	W	T	Q	SPEC
φ32	55	10	35.5	50	10*8*50
φ40	65	10	43.5	60	10*8*60
φ50	77	14	54	75	14*9*75

210筒电机直径是272mm; 定子直径210mm

SMALL AC GEAR REDUCTION MOTOR  
小型交流齿轮减速电机

5/5.5/7.5KW

立式 / VERTICAL  
单相/三相/1-PHASE/3-PHASE

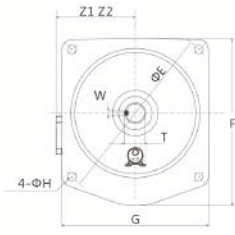
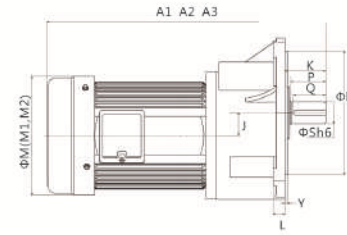

备注: A1、M1、Z1为三相马达尺寸;

A3为三相带刹车马达尺寸;

A2、M2、Z2为单相马达尺寸。

Note: A1/M1/Z1 are the sizes of three-phase motors;

A3 is the size of three-phase motors with brakes

A2/M2/Z2 are the sizes of single-phase motors

出力轴尺寸 output shaft					
出力轴 shaft	键槽 keyway			键 key	
Sh6	P	W	T	Q	SPEC
φ32	55	10	35.5	50	10*8*50
φ40	65	10	43.5	60	10*8*60
φ50	77	14	54	75	14*9*75

210筒电机直径是272mm; 定子直径210mm

外形尺寸 Overall Dimensions

功率 HP-4P	减速比 Ratio	定子直径Φ +出轴尺寸	壳壳直径																	重量 KG
			A1	A2	A3	D	E	F	G	H	L	J	K	M1	M2	X	Y	Z1	Z2	
5KW 5.5HP	3K~200K	210+50	629	629	629	170	265	335	212.5	19	30	81.92	99	212	212	325	201	167.5	167.5	60
5.5KW 7.5HP	3K~200K	210+50	611	611	611	170	265	335	212.5	19	30	81.92	99	212	212	325	201	167.5	167.5	60
7.5KW 10HP	3K~200K	210+50	645	645	645	170	265	335	212.5	19	30	81.92	99	212	212	325	201	167.5	167.5	60

容许转矩 ALLOWABLE TORQUE 单位: N.m

减速比 Ratio	3 4 5 6 7.5 9 10 12.5 15 18 20 25 30 40 50 60 75 80 90 100 110 125 140 190																								
	转速 Speed RPM	466	350	280	233	186	155	140	112	93	78	70	56	47	35	28	23.3	18.7	17.5	15.5	14	12.7	11.2	10	7.4
5KW 5.5HP	60Hz	560	420	336	280	224	186	168	134	112	93	84	67.2	56	42	33.6	28	22.4	21	18.6	16.8	15.3	13.4	12	8.8
5KW 5.5HP	Torque	85	114	142	170	213	256	284	355	426	512	568	710	852	1136	1421	1705	2131	2273	2558	2842	3126	3552	3979	5400
5.5KW 7.5HP	60Hz	112	150	187	225	281	337	375	468	562	675	750	938	1125	1500	1875	2251	2813	3001	3376	3751	4126	4689	5252	7128
5.5KW 7.5HP	Torque	94	125	156	188	234	281	312	390	469	562	625	782	938	1250	1563	1875	2344	2501	2813	3126	3433	3908	4377	5940
7.5KW 10HP	60Hz	153	204	255	306	383	460	511	639	767	921	1023	1279	1534	2046	2558	3069	3837	4092	4604	5116	5639	6395	7182	9720
7.5KW 10HP	Torque	127	170	213	255	319	383	426	532	639	767	852	1065	1279	1705	2131	2558	3197	3410	3837	4263	4681	5329	5988	8100

▲ 表列转速是基于电机异步转速 (50Hz:1400r/min, 60Hz:1680r/min), 额定负载时, 实际转速为表列转速的80%-98%。

缩框型为非正常设计使用, 如非必要请勿选用, 实际值可能与上述参数有差异, 若需具体参数, 敬请咨询本公司或浏览网站。

参数可能会因技术改进而更改, 恕不另行通知。未经允许, 不得转载本样本的图文内容。

1. The table speed is based on the asynchronous speed of the motor(50Hz:1400r/min, 60Hz:1680r/min), the actual output speed under rated torque conditions, is about 2-20% less than synchronous speed.

2. Light duty type is not available for standard application design, it is only suitable for special project design. As technical data for these machines may be advantaged, please contact us or visit the company website.

3. The specifications of the product may be modified for improvement without notice. Not allow for publish without formal approved.

黄色部分不适合重载场合使用

外形尺寸 Overall Dimensions

功率 HP-4P	减速比 Ratio	定子直径Φ +出轴尺寸	壳壳直径																	重量 KG	
			A1	A2	A3	D	E	F	G	H	L	J	K	M1	M2	X	Y	Z1	Z2		
5KW 5.5HP	3K~200K	210+50	582	582	582	280	390	361	319	19	20	72.53	85	212	212			5	159.5	159.5	60
5.5KW 7.5HP	3K~200K	210+50	611	611	611	280	390	361	319	19	20	72.53	85	212	212			5	159.5	159.5	60
7.5KW 10HP	3K~200K	210+50	645	645	645	280	390	361	319	19	20	72.53	85	212	212			5	159.5	159.5	60

容许转矩 ALLOWABLE TORQUE 单位: N.m

减速比 Ratio	3 4 5 6 7.5 9 10 12.5 15 18 20 25 30 40 50 60 75 80 90 100 110 125 140 190																								
	转速 Speed RPM	466	350	280	233	186	155	140	112	93	78	70	56	47	35	28	23.3	18.7	17.5	15.5	14	12.7	11.2	10	7.4
5KW 5.5HP	60Hz	560	420	336	280	224	186	168	134	112	93	84	67.2	56	42	33.6	28	22.4	21	18.6	16.8	15.3	13.4	12	8.8
5KW 5.5HP	Torque	85	114	142	170	213	256	284	355	426	512	568	710	852	1136	1421	1705	2131	2273	2558	2842	3126	3552	3979	5400
5.5KW 7.5HP	60Hz	112	150	187	225	281	337	375	468	562	675	750	938	1125	1500	1875	2251	2813	3001	3376	3751	4126	4689	5252	7128
5.5KW 7.5HP	Torque	94	125	156	188	234	281	312	390	469	562	625	782	938	1250	1563	1875	2344	2501	2813	3126	3433	3908	4377	5940
7.5KW 10HP	60Hz	153	204	255	306	383	460	511	639	767	921	1023	1279	1534	2046	2558	3069	3837	4092	4604	5116	5639	6395	7182	9720
7.5KW 10HP	Torque	127	170	213	255	319	383	426	532	639	767	852	1065	1279	1705	2131	2558	3197	3410	3837	4263	4681	5329	5988	8100

▲ 表列转速是基于电机异步转速 (50Hz:1400r/min, 60Hz:1680r/min), 额定负载时, 实际转速为表列转速的80%-98%。

缩框型为非正常设计使用, 如非必要请勿选用, 实际值可能与上述参数有差异, 若需具体参数, 敬请咨询本公司或浏览网站。

参数可能会因技术改进而更改, 恕不另行通知。未经允许, 不得转载本样本的图文内容。

1. The table speed is based on the asynchronous speed of the motor(50Hz:1400r/min, 60Hz:1680r/min), the actual output speed under rated torque conditions, is about 2-20% less than synchronous speed.

2. Light duty type is not available for standard application design, it is only suitable for special project design. As technical data for these machines may be advantaged, please contact us or visit the company website.

3. The specifications of the product may be modified for improvement without notice. Not allow for publish without formal approved.

黄色部分不适合重载场合使用

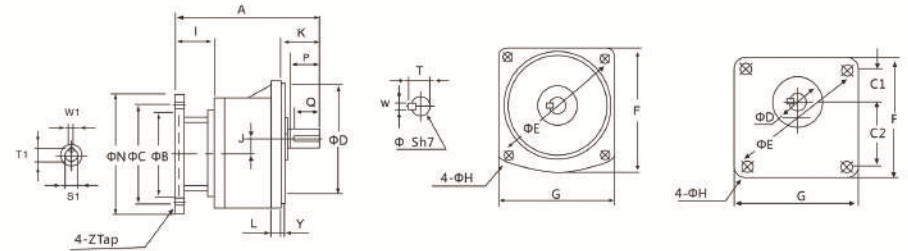
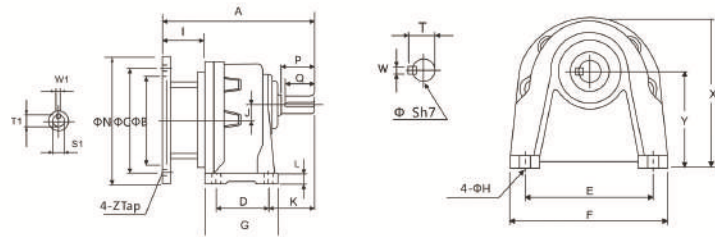

外形尺寸 Overall Dimensions 卧式 HORIZONTAL

功率/马力 W/HP	减速比 Gear ratio	型号 Type	A	B	C	D	E	F	G	H	I	J	K	L	N	Y	Z	重量 KG
200W	3-30	18	155	110	130	40	110	134.5	65	9	52.5	16	48	9.5	160	90	M8	4
	40-128	18	165	110	130	40	110	134.5	65	9	52.5	16	48	9.5	160	90	M8	6
	2.5-200	22	186.5	110	130	65	130	158.5	90	11	52.5	18.2	55/60	15	160	98	M8	6
400W	2.5-200	22	186.5	110	130	65	130	158.5	90	11	52.5	18.2	55/60	15	160	98	M8	6
	2.5-200	28	214	110	130	90	140	178.5	120	12.5	52.5	20.8	64/60.5	17	160	117	M8	6
	3-200	32	251	110	130	130	170	213.5	160	14	52.5	30.2	75.5	26	160	140	M8	8
750W	2.5-200	28	251	130	165	90	140	178.5	120	12.5	52.5	20.8	64/60.5	17	200	117	M10	11
	3-200	32	290	130	165	130	170	213.5	160	14	91.5	30.2	75.5	26	200	140	M10	26
	3-300	40	318.5	130	165	150	210	264	190	16	91.5	42.2	84	25	200	162	M10	38
1500W	3-200	32	290	130	165	130	170	213.5	160	14	91.5	30.2	75.5	26	200	140	M10	26
	3-300	40	318.5	130	165	150	210	264	190	16	91.5	42.2	84	25	200	162	M10	39
	3-300	40	317	180	215	150	210	264	190	16	94	42.2	84	25	250	162	M12	39
2200W	3-300	40	317	180	215	150	210	264	190	16	94	42.2	84	25	250	162	M12	39
3700W	3-200	50	360.5	180	215	170	265	335	212	19	94	51.7	99	25	250	200	M12	44
5.5/7.5KW	3-200	50	390	230	265	170	265	335	212	19	126	51.7	99	25	300	200	M12	55

外形尺寸 Overall Dimensions 立式 VERTICAL

功率/马力 W/HP	减速比 Gear ratio	型号 Type	A	B	C	D	E	F	G	H	I	J	K	L	N	Y	Z	重量 KG
200W	3-30	18	155	110	130	50	140	119.5	120	9	52.5	16	39	12	160	4	M8	4
	40-128	18	165	110	130	50	140	119.5	120	9	52.5	16	39	12	160	4	M8	6
	2.5-200	22	186.5	110	130	148	185	169	155	11	52.5	18.2	48.5	12	160	3.5	M8	6
400W	2.5-200	22	186.5	110	130	148	185	169	155	11	52.5	18.2	48.5	12	160	3.5	M8	6
	2.5-200	28	215	110	130	170	220	194	180	13	52.5	20.8	54	15	160	4.5	M8	6
	3-200	32	251	110	130	185	255	239	223	14	52.5	30.2	62	17	160	4	M8	8
750W	2.5-200	28	251	130	165	170	220	194	180	13	91.5	20.8	54	15	200	4.5	M10	11
	3-200	32	290	130	165	185	255	239	223	14	91.5	30.2	62	17	200	4	M10	26
	3-300	40	318.5	130	165	229.5	310	300	274.5	16	91.5	42.2	76	21	200	5	M10	38
1500W	3-200	32	290	130	165	185	255	239	223	14	91.5	30.2	62	17	200	4	M10	26
	3-300	40	318.5	130	165	229.5	310	300	274.5	16	91.5	42.2	76	21	200	5	M10	39
	3-300	40	317	180	215	229.5	310	300	274.5	16	94	42.2	76	21	250	5	M12	39
2200W	3-300	40	317	180	215	229.5	310	300	274.5	16	94	42.2	76	21	250	5	M12	39
3700W	3-200	50	362	180	215	280	390	359	319	19	94	51.7	86	21	250	5	M12	44
5.5/7.5KW	3-25	50	390	230	265	280	390	359	319	19	126	51.7	86	21	300	5	M12	55

功率/马力 W/HP	输入轴尺寸 Input shaft dimensions				输出轴尺寸 Output shaft dimensions				
	输入轴 Input		键槽 Input		输出轴 Output shaft		键槽 Input		键 Key
	S1	W1	T1	Sh7	P	W	T	Q	SPEC
200W	Φ11	4	12.8	Φ18	30	5	20	25	5x5x25
400W	Φ14	5	16.3	Φ28	43	7	31	40	7x7x40
750W	Φ19	6	21.8	Φ32	55	10	35.5	50	10x8x50
				Φ28	43	7	31	40	7x7x40
1.5KW	Φ24	8	27.3	Φ32	55	10	35.5	50	10x8x50
				Φ40	65	10	43.5	60	10x8x60
2.2KW	Φ28	8	31.3	Φ40	65	10	43.5	60	10x8x60
3.7KW	Φ28	8	31.3	Φ50	77	14	53.5	75	14x9x75
5.5KW	Φ38	10	41.3	Φ50	77	14	53.5	75	14x9x75

功率/马力 W/HP	输入轴尺寸 Input shaft dimensions				输出轴尺寸 Output shaft dimensions				
	输入轴 Input		键槽 Input		输出轴 Output shaft		键槽 Input		键 Key
	S1	W1	T1	Sh7	P	W	T	Q	SPEC
200W	Φ11	4	12.8	Φ18	30	5	20	25	5x5x25
400W	Φ14	5	16.3	Φ28	43	7	31	40	7x7x40
750W	Φ19	6	21.8	Φ32	55	10	35.5	50	10x8x50
				Φ28	43	7	31	40	7x7x40
1.5KW	Φ24	8	27.3	Φ32	55	10	35.5	50	10x8x50
				Φ40	65	10	43.5	60	10x8x60
2.2KW	Φ28	8	31.3	Φ40	65	10	43.5	60	10x8x60
3.7KW	Φ28	8	31.3	Φ50	77	14	53.5	75	14x9x75
5.5KW	Φ38	10	41.3	Φ50	77	14	53.5	75	14x9x75